

1/10th 4WD Electric Power R/C Monster Sand Rail Truck

Specifications:

| LENGTH | WIDTH | HEIGHT | WHEEL BASE | DRIVE SYSTEM | WHEEL DISTANCE | GEAR RATIO | SERVO |
|--------|-------|--------|------------|-----------------|----------------|------------|---------|
| 435mm | 315mm | 195mm | 265mm | 4WD Shaft Drive | 260mm | 1:10.3 | 6kg/3kg |

| Styles | Motor | KV (Brushless Motor) | Motor RPM range | Battery Specification | ESC Specification | ESC Temperature protection | Under Voltage Protection | Gear Ratio | Speed |
|---------------------------|-------|----------------------|----------------------|---|---|----------------------------|--------------------------|------------|--------------|
| Brush Version | Re540 | | 20000rpm | NiMH-7.2V-1800mAh | Continue Forward 150A/Continue outward 100A | | | 1/10.3 | 28KM |
| Brushless Version (RC540) | 3650 | 3300KV | 23760rpm 24420rpm | NiMH-7.2V-2000mAh LiPO-7.4V-3600mAh 25C | Brushless 45A | 98(+/-3-5 centigrade) | below 5V1A | 1/8.9 | 40KM 48KM |
| TOP Brushless Edition | 3650 | 2724KV | 22882rpm 30236rpm | NiMH-8.4V-3000mAh LiPO-11.1V-3600mAh 25C | Brushless 45A w/Fan | 98(+/-3-5 centigrade) | below 7.2V1A | 1/8.9 | 60KM |

Spare Part

| | | | | |
|-----------------------|--|-----------------------------|--|----------------------------------|
| 12001-Front Lower Arm | 12002-Rear Lower Arm | 02014-Steering Hub (L/R) | 02015-Front Hub Carrier (L/R) | 02013-Rear Upright+Set Screw 4*4 |
| 02033-Wheel Axle | 02016-Universal Joint Cup B+ GrubScrew | 02032-Universal Joint Cup C | 20709-Front Shook Tower | 20710-Rear Shook Tower |
| 02372-Servo Arm | 2530-Power Commutator | 06002-Shock Absorber | 03007-Motor Mount | 03300-Motor Heat Proof Cover |
| 28446-Motor (Rc550) | 02500-Motor Line | 11119-Motor Gear (17T) | 08074-Crown Gear (38T) (Copper infiltration) | 11164-Diff.Main Gear (64T) |

Spare Part

| | | | | |
|-------------------------------------|---|--------------------------------|--------------------------------------|---------------------------------|
| 02024-Diff.Main Gear Complete | 03015-Drive Gear Shaft+E-Clips | 02066-Diff.Pinions+ Pin | 02039-Differential Box+Seals+Washers | 20721-Gear Shelter |
| 02051-Gear Box | 20701-Chassis | 20702-Radio Tray | 03013-Radio Tray Mount | 20708-Battery Cover |
| 03014-Battery (7.2V 1800mAh) | 20723-Battery Cover Post | 20704-Steering Ackerman Joint | 20706-Steering Set A | 20705-Steering Set B |
| 12005-Front/Rear Link 50mm | 12006-Steering Link 44mm | 10391-Servo Link | 20722-Front/Rear Suspension Mount | 20703-Front/Rear Suspension Pin |
| 06018-Front Lower Arm Pin B3*27.5mm | 06019-Rear Lower Arm Round Pin B 3*24.5mm | 12007-Front/Rear Dogbone 100mm | 20720-Centre Drive Joit(164.5mm) | 02057-Antenna Pipe |
| 08027-Pin 2*10mm | 20101-Pin 2*6mm | 20120-Front Bumper | 20102-Front Bumper (Optional) | 20103-Rear Bumper |
| 20104-Front/Rear Post Mount | 20105-Control Board | 20106-Roll Cage | 20107-Roll Cage A/B (Optional) | 20108-Roll Cage C |

Monster Sand Rail Truck Full Assembly View (1)

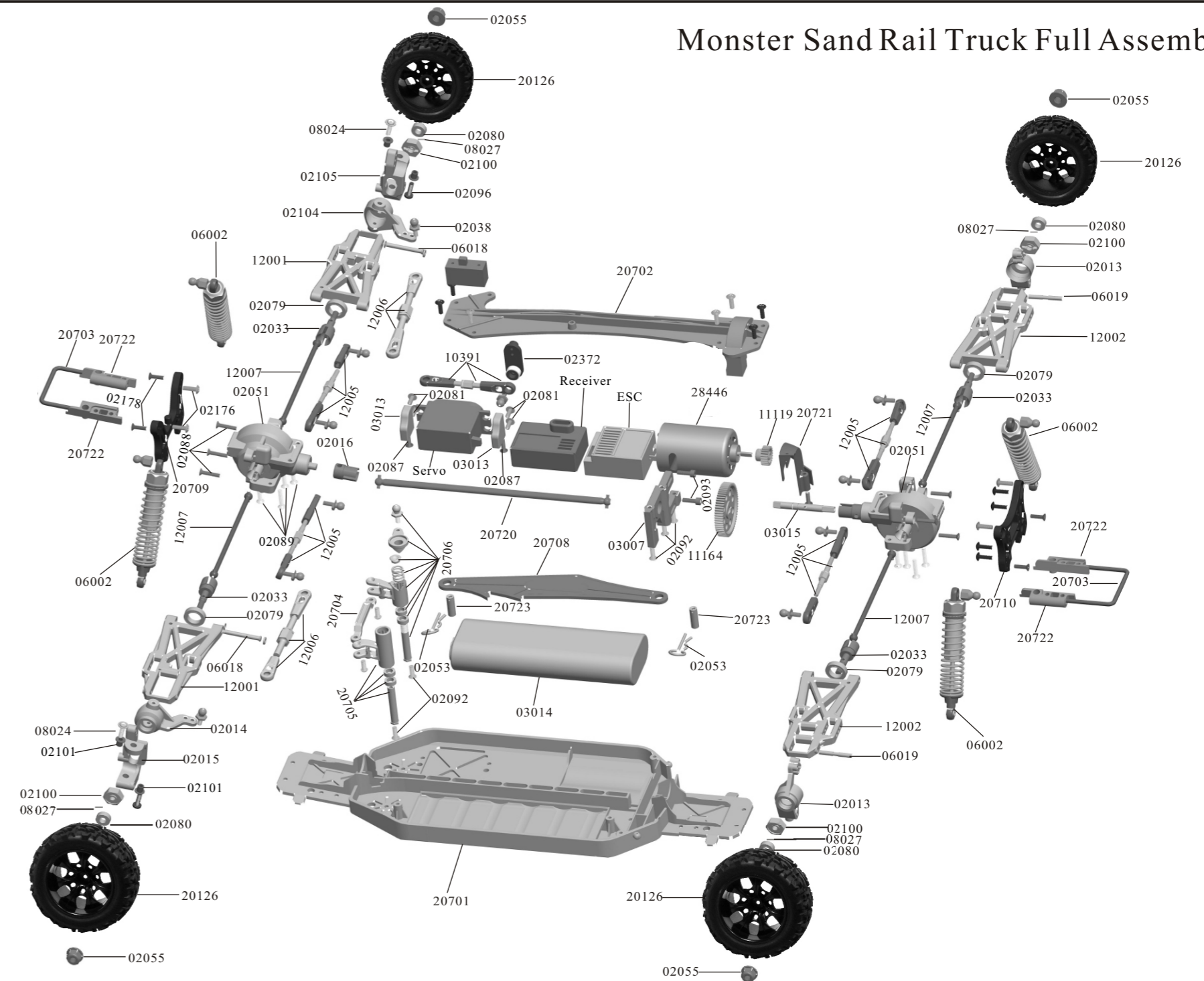

Spare Part

| | | | | |
|---|--|--------------------------------------|--|--|
| 20109-Roll Cage F | 20110-Helmet+BT2*6 BH Screw | 08008N-Wheel Rim | 31103-Tyre+Insert Sponge | 20126-Wheel Complete |
| 68018-Body Post | 20116-Shock Ball Stud B | 02053-R- Clip | 02101-Steering Bushing | 02103- Zip Tie |
| 02100- Wheel Hex. | 02037-E-Clip (Ø7Ø4Ø2.5 Ø2.3) | 02079-Oil Bearing Ø15*Ø10*4 | 02080-Oil Bearing Ø5*Ø10*4 | 02078-O-Ring |
| 02138-Ball Bearing Ø15*Ø10*4 | 02139-Ball Bearing Ø10*Ø5*4 | 06007-Link Ball Head | 02102-M3 NylonLock Nut | 02055-Nylon Locknut M4 |
| 02038-Ball Head Screw | 02098- Grub Screw M3*4 | 02099- Grub Screw M4*4 | 02127-M3*14 Grub Hex. Screw 10P | 06080-M3*12 Grub Hex. Screw 10P |
| 08024- Discal Screw M3*11 | 18243-3*8 Cap Head Machine Screw 10P | 02176-3*12 Cap Head Machine Screw 4P | 02096-3*10 Cap Head Machine Screw 6P | 02081-Cap Head Self-Tapping Screw 3*8 6P |
| 02082-Cap Head Self-Tapping Screw 3*10 10P | 02086-Round Head Self-Tapping Screw 2*10 10P | 58058-BT2*6 BH Screw 6P | 02087-Countersunk Cross Head Self-Tapping Screw 3*10 15P | 02088-Countersunk Cross Head Self-Tapping Screw 3*14 13P |
| 02089-Countersunk Cross Head Self-Tapping Screw 3*15 9P | 02178-Countersunk Cross Head Self-Tapping Screw 3*12 10P | 02092-ISO 3*10 Screw 8P | 02093-M3*10 Column Head Machine Screw 10P | |

Pro.Spare Parts

| | | | | |
|--------------------------------|-------------------------------|-------------------------------------|---------------------------------------|------------------------------------|
| 106004-Aluminum Shock Absorber | 03302-Brushless Motor KV:3300 | 102048-Aluminum Nut M3 | 102049-Aluminum Nut M4 | 1184-Diff.Main Gear 64T)Metal |
| 11181-Motor Gear (21T)Metal | 20127-Chrome Plated Spoke Rim | 20118-Chrome Plated Spoke Roll Cage | 03204-Battery LiPO (7.4V 3600mAh 25C) | 03200-Battery Ni-MH (7.2V 2000mAh) |

Upgradable Optionals

| | | | | |
|--|--|---|--------------------------------------|-----------------------------------|
| 102210-Aluminum Front Hub Carrier(L/R)+Flat Head Mechanical Screws 3*15mm*2P | 102211-Steering Hub (L/R)(AL.)+Cap Head Mechanical Screws 3*12 *2P/3*11mm*2P | 102212-Aluminum Rear Hub Carrier(L/R)+Flat Head Mechanical Screws 3*15mm*2P+M4*4 Grub Hex. Screw 2P | 102042-Aluminum Wheel Hex. Mount | 102048-Aluminum Nut M3 |
| 102049-Aluminum Nut M4 | 106004-Aluminum Shock Absorber | 120019-Aluminum Front Lower Arm | 120021-Aluminum Rear Lower Arm | 207001-Aluminum Front Shock Tower |
| 207002-Aluminum Rear Shock Tower | 207003-Aluminum Ackerman Plate | 207004-Front/Rear Suspension Mount | 28434-LiPO Battery 11.1V 3600mAh25CC | 03404-Brushless Motor KV:2724 |

Monster Sand Rail Truck Full Assembly View (2)

