

MODEL: RAMPAGE XT-E



# RAMPAGE XT-E

LARGE SCALE MONSTER TRUCK  
OWNERS MANUAL



**FAST · AFFORDABLE · FUN™**

MAN-RAMPAGEXTE-2016-12-05

- To ensure that you are using the most recent version of this manual:  
[www.redcatracing.com/manuals/RAMPAGEXTEMANUAL.pdf](http://www.redcatracing.com/manuals/RAMPAGEXTEMANUAL.pdf)
- To ensure that you have the most recent version of the Electric Vehicles Manual:  
[www.redcatracing.com/manuals/ELECTRIC-MANUAL.pdf](http://www.redcatracing.com/manuals/ELECTRIC-MANUAL.pdf)

# WARNING!

READ ALL INSTRUCTIONS INCLUDED WITH VEHICLE BEFORE OPERATING

**AGE WARNING!**

This radio controlled (RC) vehicle is not a toy! You must be 14 years of age or older to operate this vehicle. Adult supervision is required.

**RISK OF RUNAWAY VEHICLE OR INJURY!**

Never turn on the vehicle or plug in the battery pack without first having the controller turned on.

**RISK OF FIRE! / RISK OF EXPLOSION!**

There is a risk of fire and explosion when dealing with batteries. Rechargeable batteries may become hot and catch fire if left unattended or charged too quickly. Use extra caution when charging LiPO batteries. Use only LiPO specific chargers. Use a LiPO safe charging pouch when charging LiPOs. Charge away from flammable materials. Never charge at a rate higher than 1C. {2000Mah pack= 2amps charge rate). Overcharging can lead to fire and explosion. Always store battery packs in a cool dry place.

**RISK OF BURNS!**

The batteries, electronic speed controller (ESC), electric motor, and other areas of the vehicle can get hot. Burns can occur if touched after vehicle operation. Allow adequate time to cool before handling.

**RISK OF ELECTRICAL SHOCK!**

Use caution when charging batteries. Do not touch positive and negative leads together. Do not lay battery on metal. Use only chargers specified for the battery type being charged. Keep batteries and chargers away from water.

**RISK OF INJURY!**

Hobby grade RC vehicles can cause serious injury or death if not operated correctly. Never use vehicle in crowds. Never chase people or animals. Drive in safe open areas only. Keep body parts away from moving parts.

**RISK OF DAMAGE!**

Never operate RC vehicles on public roads. Damage of vehicle and property can occur. Only operate on open private property. Never charge the battery pack while it is still plugged into the RC vehicle. Always unplug the battery pack from the electronic speed controller (ESC) and remove the battery from the RC vehicle before charging. Failure to do so will result in damage to the vehicle's electronics.

**WARNING!**

Do not mix old and new batteries. Do not mix alkaline, lithium, standard (carbon zinc), or rechargeable (nickel cadmium) batteries. Do not change or charge batteries in a hazardous location.



**FCC Compliance Statement!** The radio included with your vehicle complies with part 15 of the FCC Rules. Operation is subject to the following two conditions: (1) This device may not cause harmful interference, and (2) This device must accept any interference received, including interference that may cause undesired operations. Note: This equipment has been tested and found to comply with the limits for a Class B digital device, pursuant to Part 15 of the FCC Rules. These limits are designed to provide reasonable protection against harmful interference in a residential installation. This equipment generates, uses and can radiate radio frequency energy and, if not installed and used in accordance with the instructions, may cause harmful interference to radio communications. However, there is no guarantee that interference will not occur in a particular installation. If this equipment does cause harmful interference to radio or television reception, which can be determined by turning the equipment off and on, the user is encouraged to try to correct the interference by one of the following measures:

Reorient or relocate the receiving antenna.

Increase the separation between the equipment and receiver.

Connect the equipment into an outlet on a circuit different from that to which the receiver is connected.

Consult the dealer or an experienced radio/TV technician for help.

**WARNING:** Any changes or modifications not expressly approved by the party responsible for compliance could void the user's authority to operate this equipment.

**WARNING:** While operating the Radio, a separation distance of at least 20 centimeters must be maintained between the radiating antenna and the body of the user or nearby persons in order to meet the FCC RF exposure guidelines.

# FEATURES & SPECIFICATIONS

- Powerful 980KV Brushless Electric Motor
- 150A Brushless ESC
- 4 Wheel Drive
- Aluminum Oil Filled Shocks
- Qty.2 - 11.1v 3900mAh LIPO Batteries
- LIPO Charger Included
- 2.4GHz Radio System
- Scale: 1/5
- Length: 750mm
- Width: 540mm
- Height: 320mm
- Wheelbase: 500mm
- Ground Clearance: 40mm

## VEHICLE OVERVIEW

- A: On/Off Switch
- B: Motor
- C: ESC
- D: Receiver
- E: Steering Servo
- F: Steering Linkage
- G: LiPo Batteries (2)
- H: Battery Straps
- I: Battery Boxes

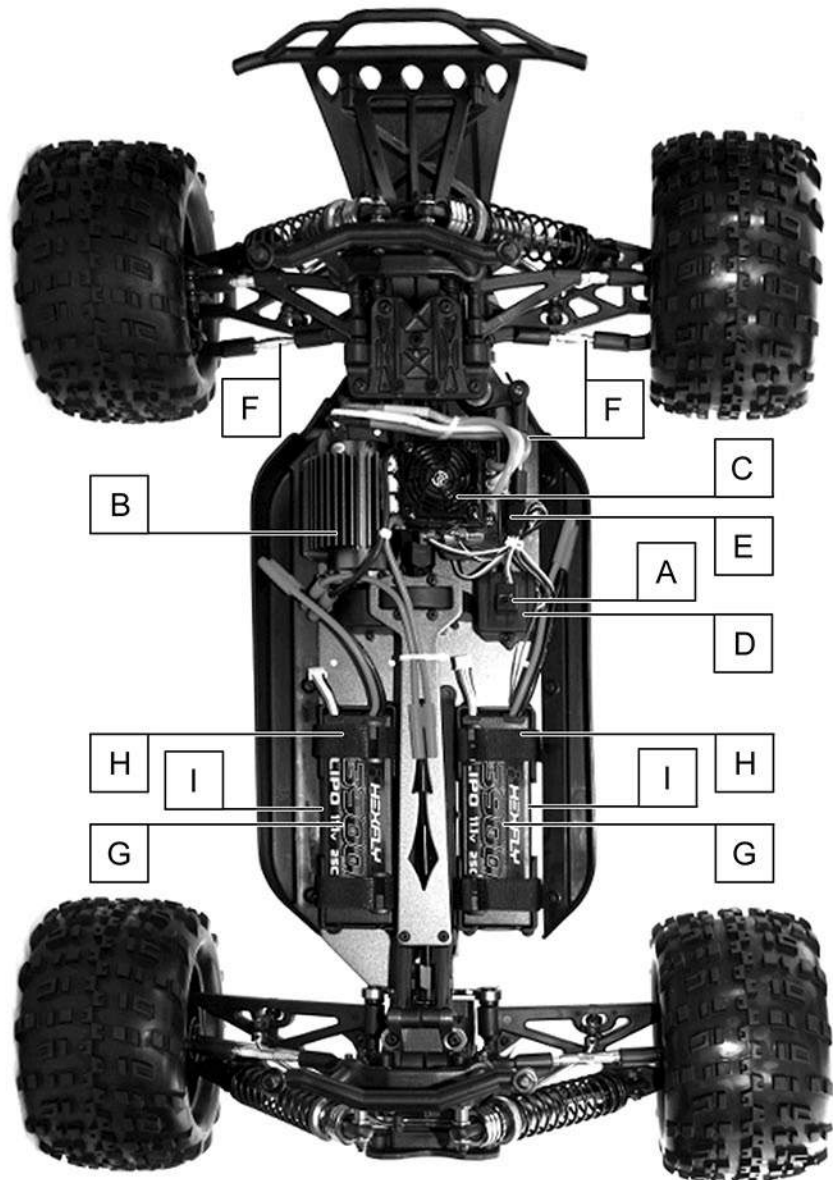

# RADIO GUIDE

**RCR-2C**  
 2.4 GHZ RADIO

CONTROL PANEL

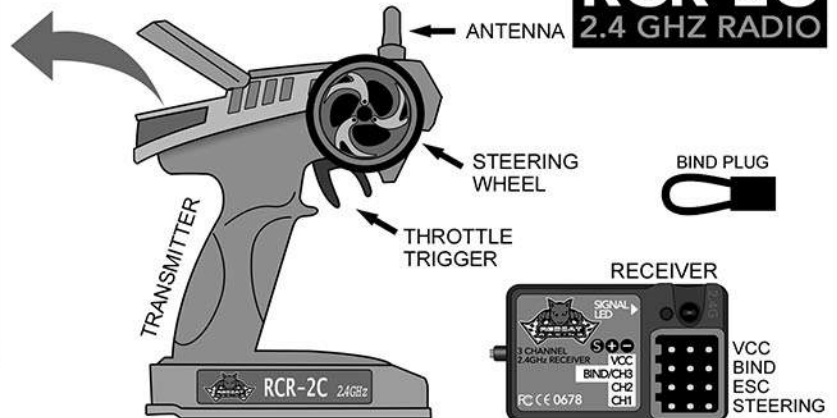

**Steering Reverse Switch:** Top left switch. Used to change steering orientation. If the car turns right when you steer left, flip this switch.

**Throttle Reverse Switch:** Top right switch. Used to change throttle trigger orientation. If the car goes in reverse while you pull the throttle trigger, flip this switch.

**Power LED:** Left LED light. Lights up when the transmitter is turned on.

**Battery Level LED:** Right LED light. Lights up green when transmitter batteries are full. Flashes when transmitter batteries are low and need replacing.

**Bind Button:** Used to bind the transmitter to the receiver. See binding instructions.

**Steering Trim:** Left knob. Used to set the steering neutral point. If the vehicle veers in one direction while the steering wheel is centered, turn this knob in the opposite direction until the car drives straight.

**Throttle Trim:** Middle knob. Used to set the throttle neutral point. If the vehicle moves forward or reverse while the throttle trigger is centered, turn this knob until the vehicle remains still. For maximum setting, turn slowly until the vehicle creeps forward, then turn the knob the opposite direction until the car stops.

**Steering Dual Rate:** Right knob. Used to limit the amount of steering. 0= little/no steering & 6= maximum steering. Set the knob to the amount of steering you feel comfortable with. If the vehicle has a tendency to spin out, lower the steering rate.

**On/Off Switch:** Bottom switch. Turns transmitter On and Off.

**VCC:** Not used.

**Bind/Ch3:** Used when binding to transmitter. Used for 3rd channel when needed.

**Ch2:** Used for Electronic Speed Controller.

**Ch1:** Used for steering servo.

### Binding:

1. Insert the BIND PLUG into the receiver BIND port.
2. Make sure your ESC is plugged into CH2, and insert the bind plug into BIND/CH3. Now, power the vehicle on and the receiver light should begin to blink red.
3. Press the BIND button in the center of the transmitter's Control Panel and turn on radio.
4. Release the bind button when you see the green light on the radio flashing. At this point, your receiver's LED should now be solid red. Turn off the power to your vehicle, as well as the radio.
5. Remove the BIND PLUG from the receiver. Make sure the servos and ESC are attached as described above.
6. First turn your radio on, then your vehicle as normal. Your radio and receiver should be bound together and communicating with each other.

# LIPO CHARGER

## Specifications: HX-A3 Charger

- AC input : 100-240V
- Charges LiPo batteries: 2S - 3S
- Charge current: 900mAh x 3
- Two output ports: 1x2S, 1x3S LiPo Balance ports

### - ATTENTION -

When plugging the battery pack into the ESC, make sure the plugs are lined up correctly!

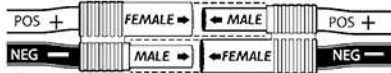

Ensure POS+ wire is connected to POS+ & NEG- is connected to NEG-

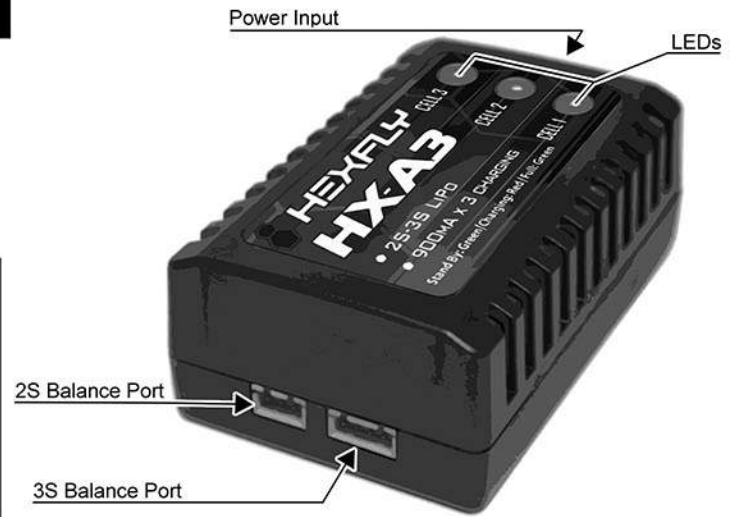

## Charging Instructions:

1. Plug the charger into an AC power supply (100-240V)
2. Once connected to a power supply, all the LED lights will turn green.
3. Plug in a 2S or 3S LiPo battery, that has been unplugged and removed from the RC vehicle, into the corresponding balance port. 2S for 2S battery packs & 3S for 3S battery Packs. NOTE: LiPo batteries have 2 plugs on them, 1x main plug (large plug used to plug into the RC car) & 1x balance plug (small white plug used for charging). ENSURE THE LARGE MAIN PLUG IS DISCONNECTED FROM THE VEHICLE AND ISN'T PLUGGED INTO ANYTHING WHILE CHARGING THE BATTERY WITH THE HX-A3 CHARGER!
4. LED lights will turn red. This means the battery is charging.
5. LED lights turn green when the corresponding battery cells are fully charged. When all LEDs are green, the battery pack is completely charged.
6. Unplug the battery pack from the charger.
7. Unplug the charger from the power supply.

## ⚠ Warnings:

- Unplug battery from ESC and remove battery from vehicle **BEFORE** plugging battery into charger.
- Do Not plug the battery into a vehicle while the battery is plugged into the charger. Damage to the ESC and charger may occur.
- Read the entire manual carefully before attempting to plug in or attempting to use the charger.
- Keep charger, included hardware, and batteries away from water, corrosive gases, dust, and damp environments.
- Only charge LiPo batteries. Cell count: 1 x 2S or 1 x 3S
- Do not attempt to charge 2S and 3S batteries at the same time, one or the other!
- Incorrect connections may cause permanent damage to batteries, charger, property, and persons.
- Only use included cables, adapters, and accessories, as others may cause permanent damage to batteries, charger, property, and persons.

## Warranty Info:

This product includes a 90 day warranty against factory defects. Warranty starts at date of purchase and the original product receipt is necessary for all warranty claims. This warranty does not cover improper use or any use other than specified as proper use in this manual.

# EXPLODED VIEWS

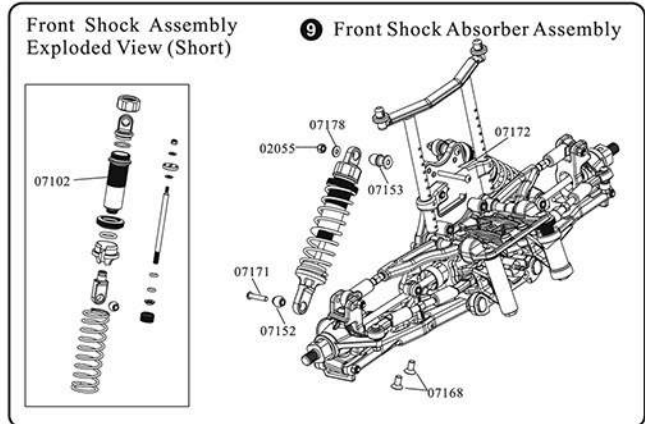
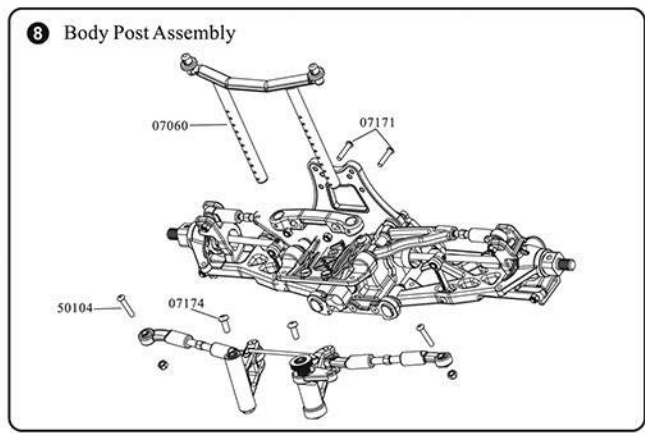
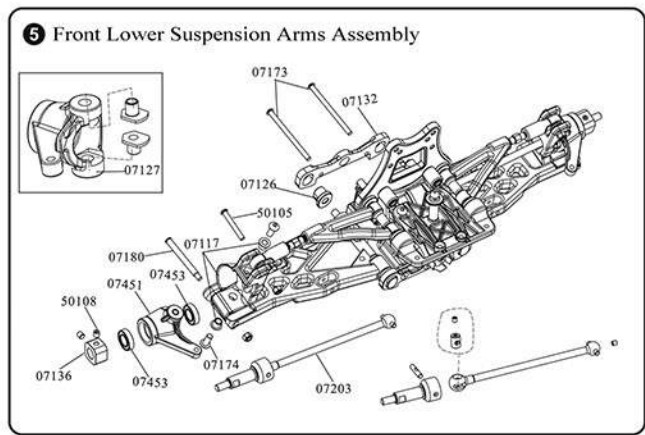
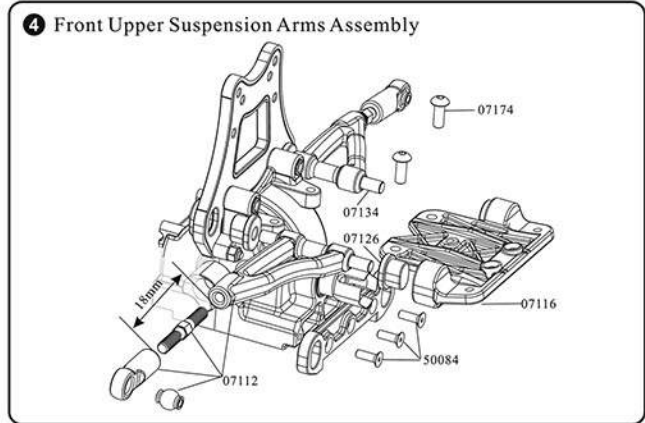
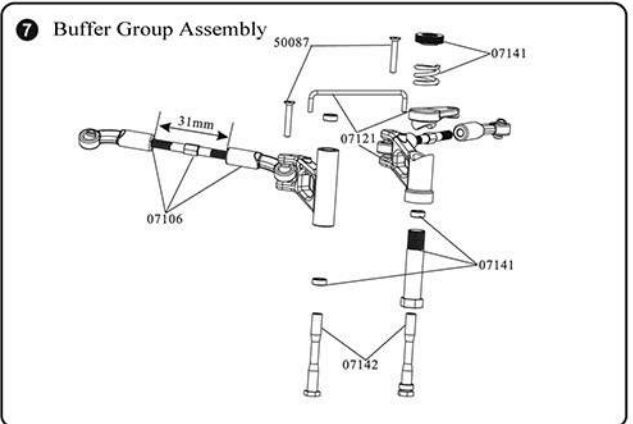
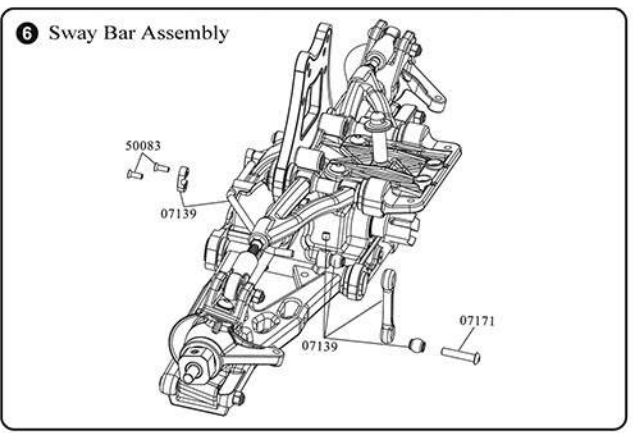
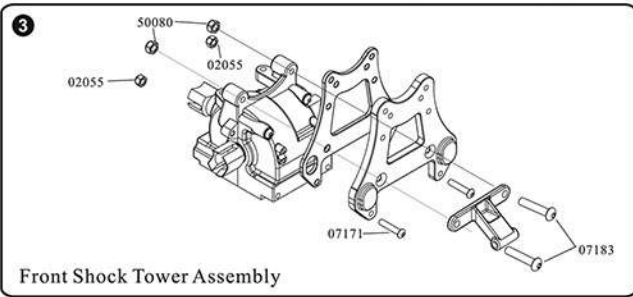
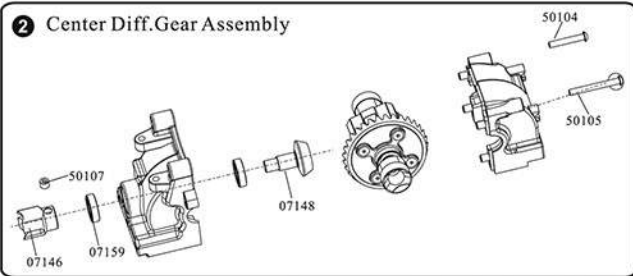
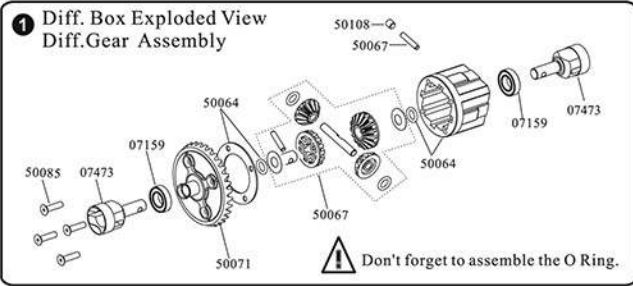

# EXPLODED VIEWS

10 Front Bumper Assembly

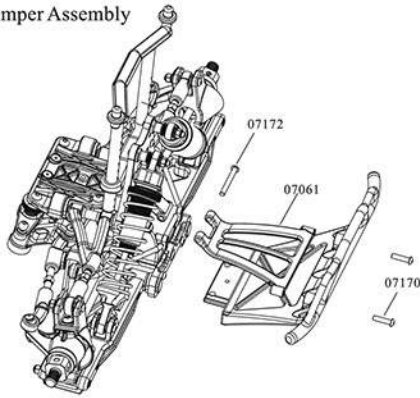

12 Rear Lower Suspension Arms Assembly

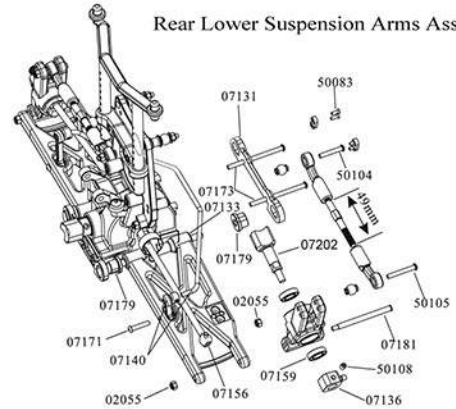

11 Rear Shock Tower Assembly

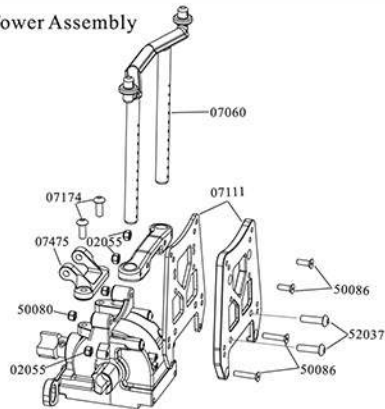

Rear Shock Assembly Exploded View (long)



13 Rear Shock Absorber Assembly

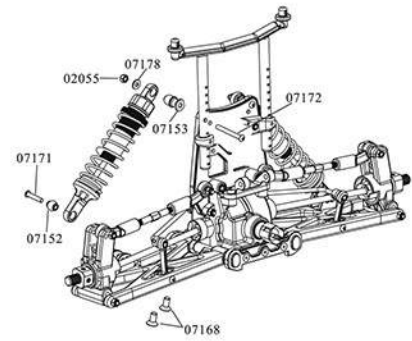

14 Motor Set Assembly

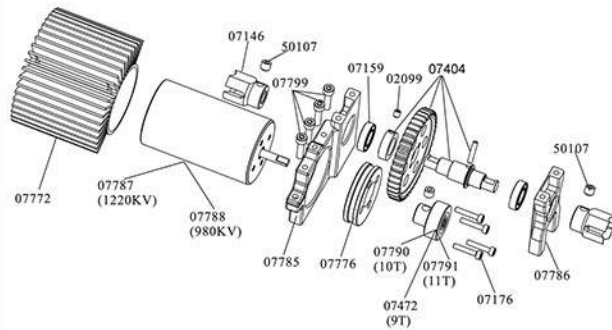

16 Battery Assembly

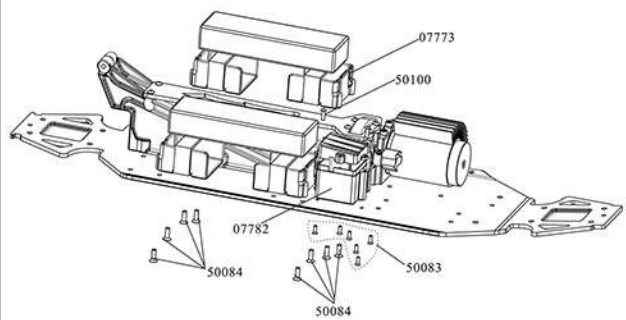

15 Bracing and Motor Set Assembly

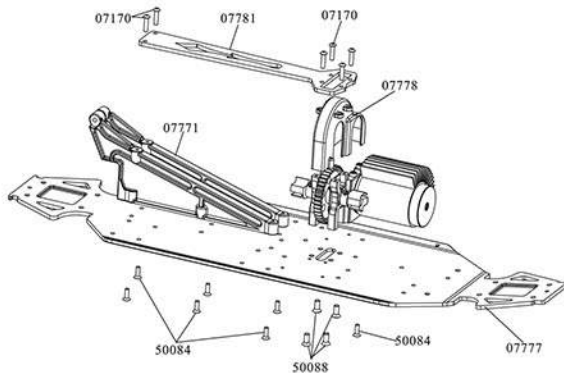

17 Servo and ESC Mounting Tray Assembly

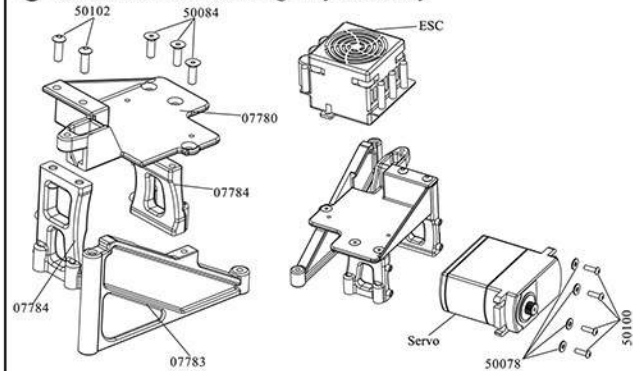

# EXPLODED VIEWS

18 Servo and Chassis Assembly

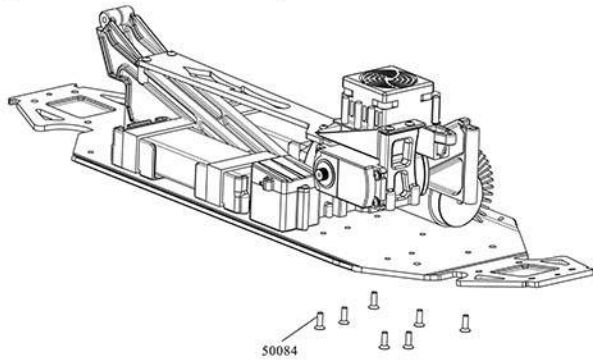

20 Side Guard Assembly

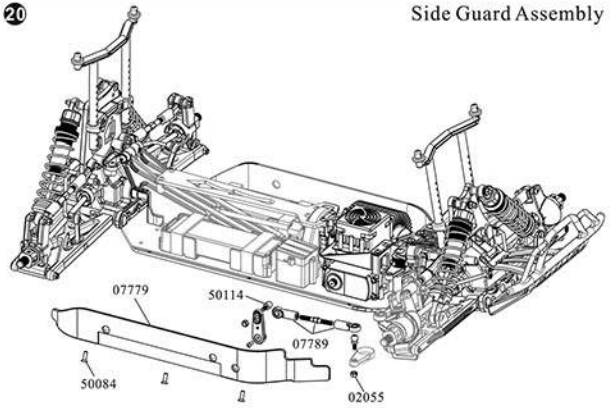

19 Front/Rear Unit Assembly

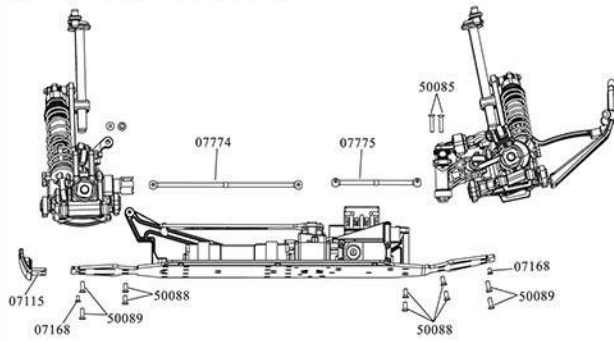

21

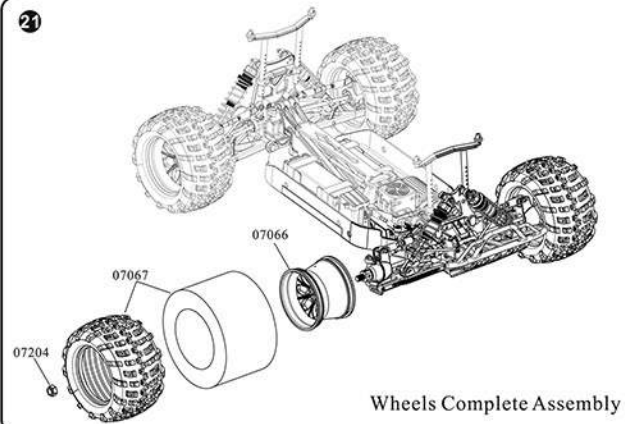

Wheels Complete Assembly



# PARTS IDENTIFICATION

<p>07771-Rear Chassis Brace</p> 	<p>07772-Motor Heat Sink</p> 	<p>07773-Battery Case</p> 	<p>07774-Rear Dogbones (210mm)</p> 
<p>07775-Front Dogbones New length: 122mm (Old length: 118mm)</p> 	<p>07776-Motor Mount</p> 	<p>07777-Chassis</p> 	<p>07778-Dust Cover</p> 
<p>07779-Side Guard(L/R)</p> 	<p>07780-ESC Mount</p> 	<p>07781-Chassis Brace</p> 	<p>07782-Receiver Case</p> 
<p>07783-Front Brace</p> 	<p>07784-Servo Mount</p> 	<p>07785-Center Diff. Mount A/ Motor Mount</p> 	<p>07786-Center Diff. Mount B</p> 
<p>07789-Servo Link</p> 	<p>07472-Pinion Gear (9T)</p> 	<p>07790-Pinion Gear (10T)</p> 	<p>07403-Pinion Gear (11T)</p> 
<p>07404-Spur Gear (41T)</p> 	<p>07108-Gear Box</p> 	<p>50064-Front/Rear Diff. Case</p> 	<p>50067-Front/Rear Diff. Gear Set</p> 
<p>50071-Front /Rear Crown Gear (33T)</p> 	<p>07102- Front Shock Absorber</p> 	<p>07103- Rear Shock Absorber</p> 	<p>07110-Front Shock Tower</p>  <p>Plastic      AL.</p>

# PARTS IDENTIFICATION

<p>07111-Rear Shock Tower</p>  <p>Plastic AL.</p>	<p>07104-Front Lower Suspension Arm(L/R)</p> 	<p>07105-Rear Lower Suspension Arm(L/R)</p> 	<p>07106-Steering link</p> 
<p>07107-Rear upper link</p> 	<p>07112-Front Upper Suspension Arm(L/R)</p> 	<p>07116-Front Upper Top Plate</p> 	<p>07115-Bumper</p> 
<p>07061-Front Bumper</p> 	<p>07060-Body Post</p> 	<p>07117-Steering Mount(L/R)</p> 	<p>07121-Steering Rocker</p> 
<p>07451-Steering Mount(L/R)</p> 	<p>07370-Rear Upright (L/R)</p> 	<p>07130-Rear Lower Sus. Arm Holder (B)</p> 	<p>07131-Rear Lower Sus. Arm Holder (C)</p> 
<p>07132-Front Lower Sus. Arm Holder (A)</p> 	<p>07118-Lower Shock Mounts</p> 	<p>07136-Wheel Mount</p> 	<p>07139-Front Stabilizer Bar</p> 
<p>07140-Rear Stabilizer Bar</p> 	<p>07133-Front/ Rear Lower Sus. Arm Pins 6*90</p> 	<p>07134-Front Upper Sus. Arm Pins 6*60</p> 	<p>07142-Buffer Post</p> 
<p>07141-Buffer Aluminium Mount</p> 	<p>07475-Rear brace</p> 	<p>07146-Center Dogbone Joint</p> 	<p>07148-Diff. Gear(11T) Steel</p> 

## PARTS IDENTIFICATION

07473-Diff.Joint Cups 	07156-Rear Dogbones New length:133mm (Old length:131mm) 	07202-Rear wheel Axle (10mm) 	07203-New Universal Drive Joint(Length:128mm) 
07452-Front wheel Axle 	07066-Wheel Rims 	07067-Tires+Insert Sponge 	07065-Wheels Complete (L/R) 
07180-Front Lower Sus.Arm Pins(Screw Thread) 5*50.5 	07181-Rear Lower Sus.Arm Pins(Screw Thread) 5*65 	07126-Center Toe Adjustment Inserts (Neutral) 	07179-Center Toe Adjustment Inserts (Offset) 
81013-Body Clips 2.0mm 	50114-Servo Link Ball 8mm 	07153-Shock Upper Ball (AL.) 	07151-Front Sus.Arm Ball (AL.) Length:12mm 
07152-Shock lower Ball(AL.) Length:10mm 	07453-Ball Bearing (22*10*6) 4P 	07159-Bearing 19*10*5mm 	07178-Second Way Gear Washer 4*10*1.0mm 
50078-Servo Washers 3*8*0.8mm 	07204-Nuts(M10) 	02102-Nuts(M3) 	02055-Nuts(M4) 
50080-Nuts(M5) 	02099-Hex Head Grub Screw (4*4) 10P 	50107-Hex Head Grub Screw (6*6) 8P 	50108-Hex Head Grub Screw (5*5) 8P 

# OPTIONAL PERFORMANCE PARTS

<p>07787-Brushless Motor 1220KV</p> 	<p>07788-Brushless Motor 980KV</p> 	<p>07793-Brushlee ESC: 125A</p> 	<p>07794-Brushlee ESC: 150A</p> 
<p>07795-Lipo Battery 7.4v 3700mAh</p> 	<p>03207-Lipo Battery 11.1V 3900mAh</p> 	<p>Sp2001- Servo(20kg)</p> 	<p>07474-New Servo (20kg)</p> 
<p>710002-Front Upper Sus. Arm</p> 	<p>710003-Front Upper Top Plate</p> 	<p>710004-Front Shock Tower</p> 	<p>710005-Rear Shock Tower</p> 
<p>710006-Rear Alxe Mount</p> 	<p>710010-Steering Mount(L/R)</p> 	<p>710011-Steering Rocker</p> 	<p>077001-Center Dogbone New length:122mm (Old length:118)</p> 
<p>710013-Strreeing Mount (L/R)</p> 	<p>710015-Front Shock Absorber (Short) (AL.)</p> 	<p>710016-Rear Shock Absorber (Long) (AL.)</p> 	<p>710017-Front Lower Sus. Arm Holder</p> 
<p>710018-Rear Lower Sus. Arm Holder</p> 	<p>710019-Front Lower Sus. Arm Holder</p> 	<p>077002-Rear Side Link (AL.)</p> 	<p>077003-Front Brace (AL.)</p> 
<p>710032- (AL.) Rear Lower Suspension (L/R)+Suspension Tab</p>  <p>4*20mm</p>	<p>710033-(AL.) Front Lower Suspension (L/R)+Suspension Tab</p>  <p>4*20mm</p>	<p>050029-Shock Absorber Protective Cap (AL.)</p> 	<p>07437-Servo Horn(Metal)</p> 



**FAST  AFFORDABLE  FUN**

[www.redcatracing.com](http://www.redcatracing.com)

 Follow us on FaceBook: <https://www.facebook.com/RedcatRacing>

MAN-RAMPAGEXTE-2016-12-05

- To ensure that you are using the most recent version of this manual:  
[www.redcatracing.com/manuals/RAMPAGEXTEMANUAL.pdf](http://www.redcatracing.com/manuals/RAMPAGEXTEMANUAL.pdf)
- To ensure that you have the most recent version of the Electric Vehicles Manual:  
[www.redcatracing.com/manuals/ELECTRIC-MANUAL.pdf](http://www.redcatracing.com/manuals/ELECTRIC-MANUAL.pdf)