



# EARTHQUAKE

OWNERS MANUAL

# 3.5

## IMPORTANT LINKS:

Link to the most recent version of this manual with exploded views and parts lists:  
[www.redcatracing.com/manuals/Earthquake35manual.pdf](http://www.redcatracing.com/manuals/Earthquake35manual.pdf)

Link to nitro vehicles manual:  
[www.redcatracing.com/manuals/NITRO-MANUAL.pdf](http://www.redcatracing.com/manuals/NITRO-MANUAL.pdf)



**WARNING!**

READ ALL INSTRUCTIONS INCLUDED WITH VEHICLE BEFORE OPERATING

**AGE WARNING!**

This radio controlled (RC) vehicle is not a toy! You must be 14 years of age or older to operate this vehicle. Adult supervision is required.

**RISK OF RUNAWAY VEHICLE OR INJURY!**

Never start the engine without first having the controller and receiver turned on, and having tested the controls to make sure everything is functioning properly.

**RISK OF FIRE! / RISK OF EXPLOSION!**

There is a risk of fire and explosion when dealing with fuel. Hobby fuels contain Nitromethane and Methyl alcohol which are highly flammable and combustible. Injury or death can occur if proper care is not followed.



Follow all precautions that go along with handling nitro fuel and never allow fuel to be near open sparks or flames of any kind. Only use fuel rated containers. Nitro fuel ignites quickly and emits fumes into the air. The entire area around the fuel may have combustible fumes in the air. This means the air around the fuel can flash ignite causing an explosion. Only use outdoors in a well ventilated area.

**POISONOUS!**

Fuels containing Nitromethane and Methyl alcohol are toxic. Injury or death can occur if swallowed. May irritate skin and cause injury if absorbed into the skin. Injury or death can occur from breathing the toxic fumes. The exhaust emitted from this Radio Control (RC) vehicle's muffler is toxic and can cause injury or death if inhaled. **KEEP AWAY FROM CHILDREN AND PETS!** Never start the engine indoors, not even in a closed garage. Always follow the appropriate nitro fuel safe handling practices.

**RISK OF BURNS!**

The engine, exhaust pipe, and other areas of the vehicle get hot. Burns can occur if touched after vehicle operation. Allow adequate time to cool before handling.

**RISK OF INJURY!**

Hobby grade RC vehicles can cause serious injury or death if not operated correctly. Never use this vehicle in crowds. Never chase people or animals. Drive in safe open areas only. Keep body parts away from moving parts.

**RISK OF DAMAGE!**

Never operate RC vehicles on public roads. Damage of vehicle and property can occur. Injury or death may also occur. Only operate on wide open private property.

**WARNING!**

Do not mix old and new batteries. Do not mix alkaline, lithium, standard (carbon zinc), or rechargeable (nickel cadmium) batteries. Do not change or charge batteries in a hazardous location.



**FCC Compliance Statement!** The radio included with your vehicle complies with part 15 of the FCC Rules. Operation is subject to the following two conditions: (1) This device may not cause harmful interference, and (2) This device must accept any interference received, including interference that may cause undesired operations. Note: This equipment has been tested and found to comply with the limits for a Class B digital device, pursuant to Part 15 of the FCC Rules. These limits are designed to provide reasonable protection against harmful interference in a residential installation. This equipment generates, uses and can radiate radio frequency energy and, if not installed and used in accordance with the instructions, may cause harmful interference to radio communications. However, there is no guarantee that interference will not occur in a particular installation. If this equipment does cause harmful interference to radio or television reception, which can be determined by turning the equipment off and on, the user is encouraged to try to correct the interference by one of the following measures:

Reorient or relocate the receiving antenna.

Increase the separation between the equipment and receiver.

Connect the equipment into an outlet on a circuit different from that to which the receiver is connected.

Consult the dealer or an experienced radio/TV technician for help.

**WARNING:** Any changes or modifications not expressly approved by the party responsible for compliance could void the user's authority to operate this equipment.

**WARNING:** While operating the Radio, a separation distance of at least 20 centimeters must be maintained between the radiating antenna and the body of the user or nearby persons in order to meet the FCC RF exposure guidelines.

# FEATURES & SPECIFICATIONS

- Powerful 3.5cc. .21 Nitro Engine
- Large 125cc Fuel Tank
- 4 Wheel Drive
- 2-Speed Transmission
- Oil Filled Big Bore Shocks
- Composite Disc Brake
- 3.0mm 6061 Aluminum Chassis
- 2.4GHz Radio System
- Scale: 1/8
- Length: 510mm
- Width: 380mm
- Height: 250mm
- Wheelbase: 325mm
- Ground Clearance: 58mm

## VEHICLE OVERVIEW

- A:** Engine
- B:** Tuned Pipe
- C:** Pull Starter
- D:** Air Filter
- E:** Fuel Tank
- F:** Receiver Battery
- G:** 2.4GHz Receiver
- H:** On/Off Switch
- I:** Throttle Servo
- J:** Disc Brake
- K:** Steering Servo
- L:** Steering Linkage
- M:** Oil Filled Shocks
- N:** Carry Handle/Roll Bar

**Note:** This vehicle requires AA batteries in both the transmitter and receiver to operate.

### WARNING!

Do not mix old and new batteries. Do not mix alkaline, lithium, standard (carbon zinc), or rechargeable (nickel cadmium) batteries. Do not change or charge batteries in a hazardous location.

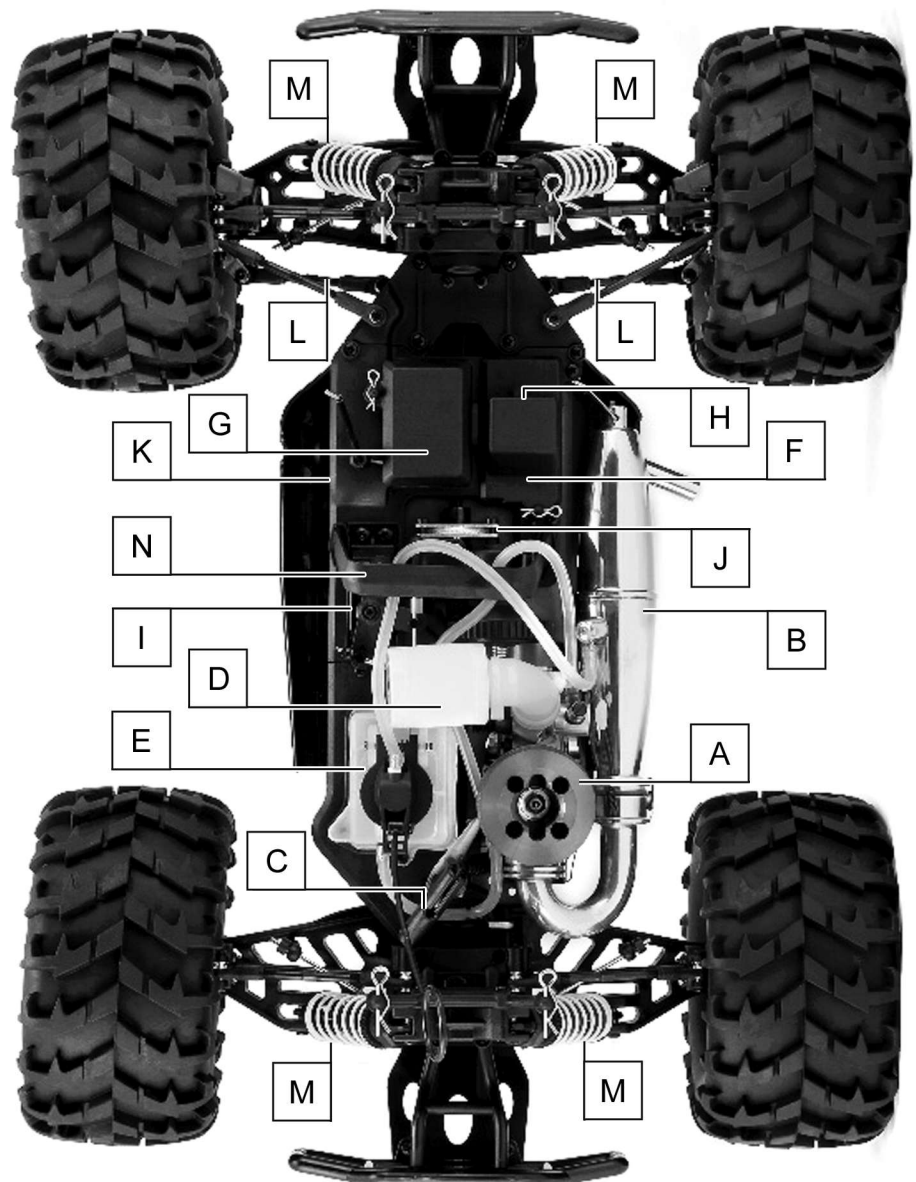

# RADIO GUIDE

CONTROL PANEL

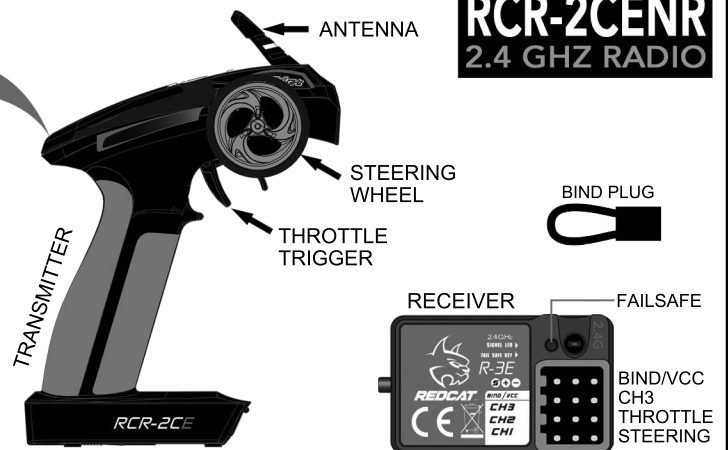
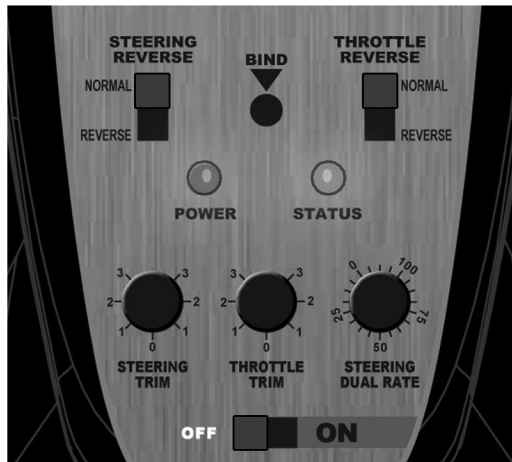

**RCR-2CENR**  
2.4 GHZ RADIO

## RADIO:

**Steering Reverse Switch:** Top left switch. Used to change steering orientation. If the car turns right when you steer left, flip this switch.

**Throttle Reverse Switch:** Top right switch. Used to change throttle trigger orientation. If the vehicle applies brakes while you pull the throttle trigger, flip this switch.

**Power LED:** Left LED light. Lights up when the transmitter is turned on.

**Status LED:** Right LED light. Lights up green when transmitter batteries are full. Flashes when transmitter batteries are low and need replacing.

**Bind Button:** Used to bind the transmitter to the receiver. See binding instructions.

**Steering Trim:** Left knob. Used to set the steering neutral point. If the vehicle veers in one direction while the steering wheel is centered, turn this knob in the opposite direction until the car drives straight.

**Throttle Trim:** Middle knob. Used to set the throttle neutral point. If the vehicle moves forward or the brake is applied while the throttle trigger is centered, turn this knob until the vehicle remains still but rolls easily. For maximum setting, turn slowly until the engine revs slightly, then turn the knob the opposite direction until it idles.

**Steering Dual Rate:** Right knob. Used to limit the amount of steering. 0= little/no steering & 100= maximum steering. Set the knob to the amount of steering you feel comfortable with. If the vehicle has a tendency to spin out, lower the steering rate.

**On/Off Switch:** Bottom switch. Turns transmitter On and Off.

## RECEIVER:

**BIND/VCC:** Used to connect the receiver battery & binding the transmitter.

**Ch3:** Used for 3rd channel when needed.

**Ch2:** Used for throttle/brake servo.

**Ch1:** Used for steering servo.

**Failsafe Button:** Used to set failsafe.

## BINDING:

1. Insert the BIND PLUG into the receiver BIND port.
2. Make sure your RX battery is plugged into CH3. Now, power the vehicle on and the receiver light should begin to blink red.
3. Press the BIND button in the center of the transmitter's Control Panel and turn on radio.
4. Release the bind button when you see the green light on the radio flashing. At this point, your receiver's LED light should pause for approximately 1 second and then blink slowly. Turn off the power to your vehicle, as well as the radio.
5. Remove the BIND PLUG from the receiver. Make sure the servos and RX battery are attached as described above.
6. First turn your radio on, then your vehicle as normal. Your radio and receiver should be bound together and communicating with each other.
7. Be sure everything is turned on and that all servos are working properly before starting the engine.

# EXPLODED VIEW

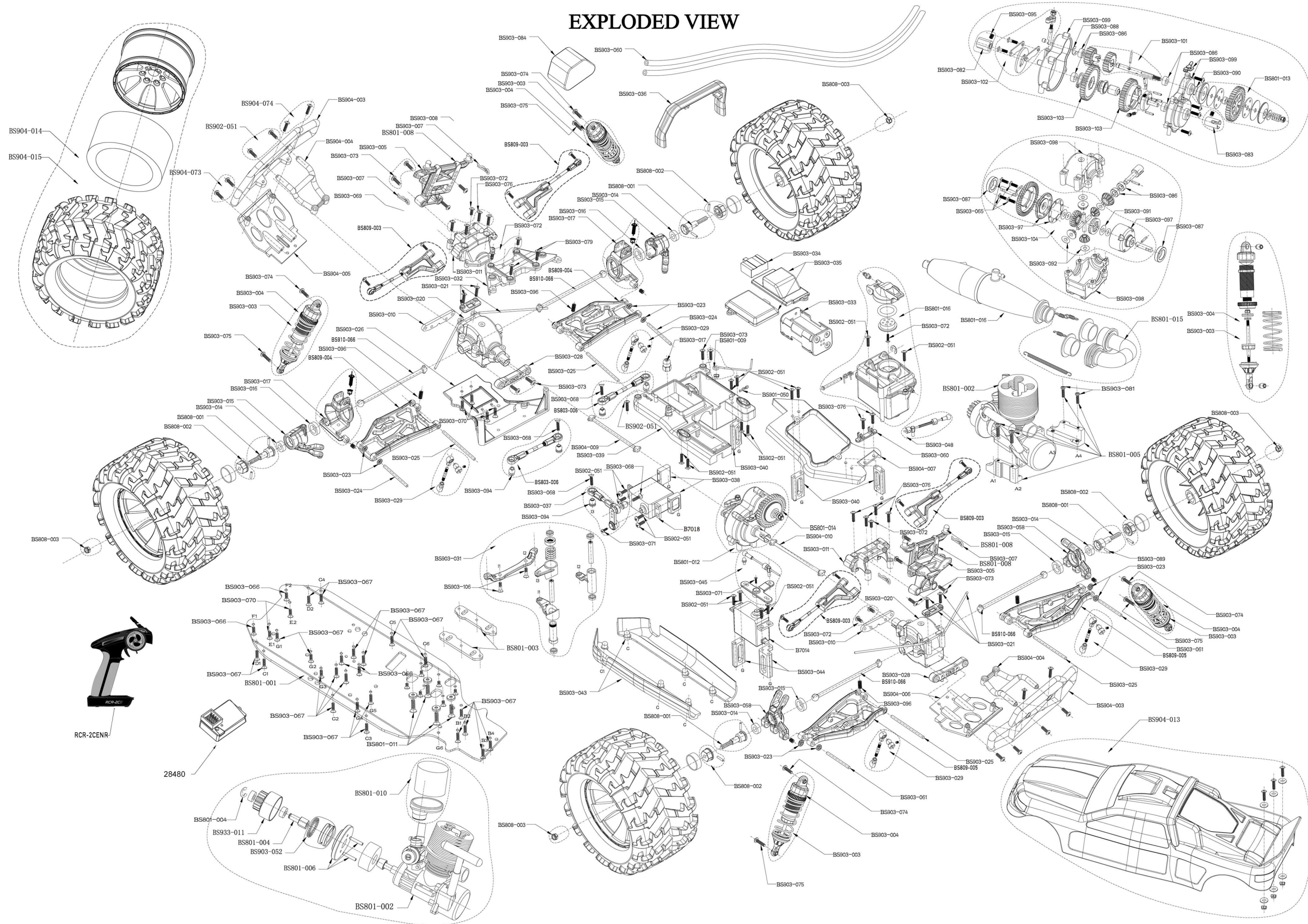

# PARTS IDENTIFICATION

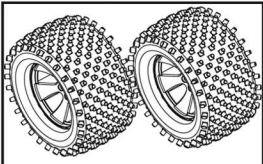

BS904-001 Mounted knobby tires/rim (white) 2pcs  
BS904-002 Mounted knobby tires/rim (chrome) 2 pcs

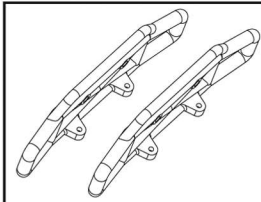

BS904-003 Bumper 2pcs

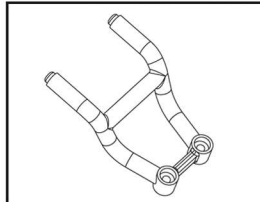

BS904-004 Bumper brace 2pcs

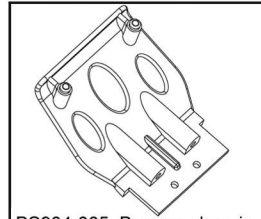

BS904-005 Bumper chassis Front 1pcs

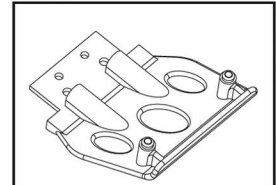

BS904-006 Bumper chassis Rear 1pcs

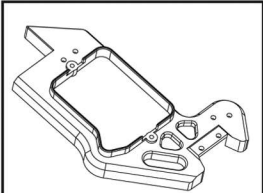

BS904-007 Upper plate Rear 1pcs

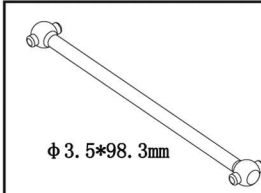

BS904-009 Dogbone Front 1pcs

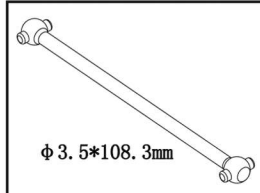

BS904-010 Dogbone Rear 1pcs

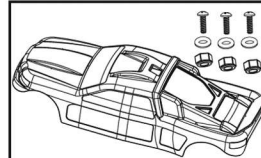

BS904-013 Silk-screened body 1pcs

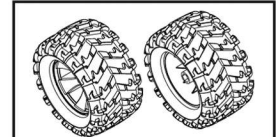

BS904-014 Mounted tire/rim (white) 2pcs  
BS904-015 Mounted tire/rim (chrome) 2pcs

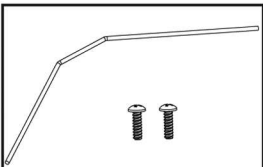

BS905-009 Rear anti-roll bar set

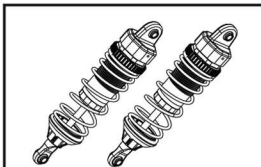

BS903-003 Shock assembly (plastic) 2pcs

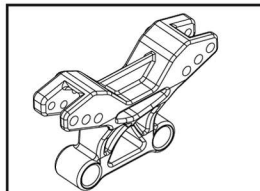

BS903-005 Shock tower Front/Rear 1pcs

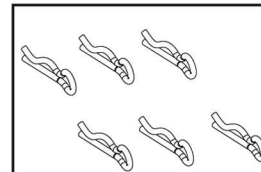

BS903-007 Body pin 6pcs

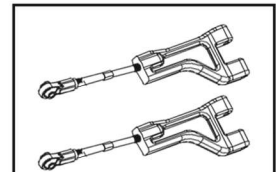

BS809-003 Upper susp. Arm set

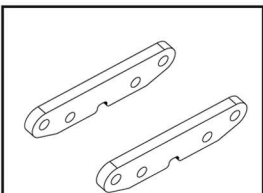

BS903-010 Suspension arm mount block 2pcs

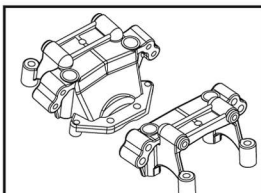

BS903-011 Upper susp. arm mount Front/Rear

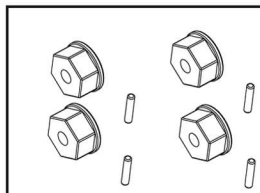

BS808-002 Rim hub w/pin 2\*10 4pcs

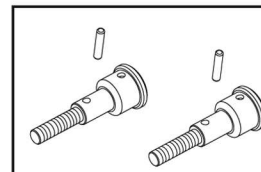

BS808-001 Axle w/pin 2pcs

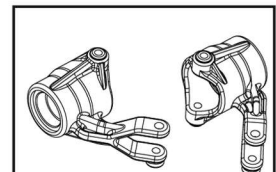

BS903-015 Steering arm 2pcs

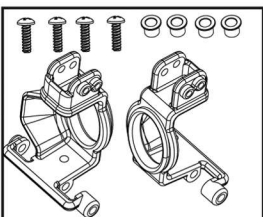

BS903-017 C-carrier w/screw

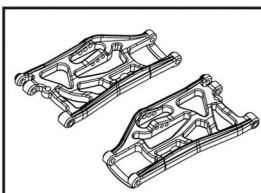

BS809-004 Front lower susp. arm Left/Right

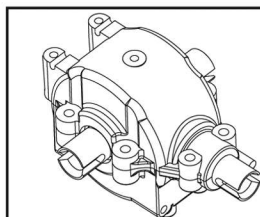

BS903-020 Diff. gearbox unit

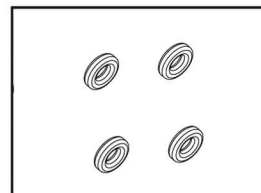

BS903-023 O-washer 4pcs

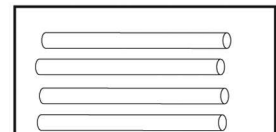

3\*37.5mm  
BS903-024 Front suspension arm pin-short 4pcs

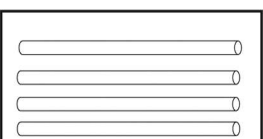

3\*56mm  
BS903-025N Susp. arm pin long 4pcs

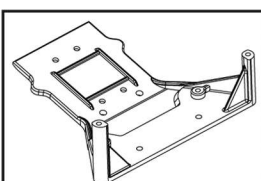

BS903-026 Front chassis

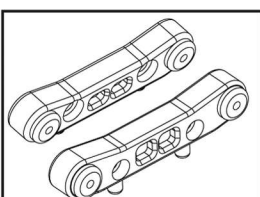

BS903-028 Lower susp. mount block front/rear

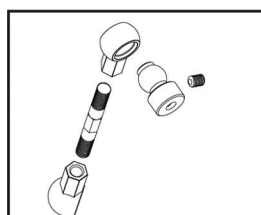

BS903-029 Anti-roll bar mount set

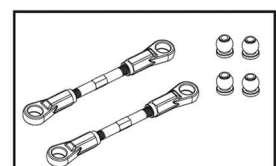

BS803-006 Servo saver link 2pcs

# PARTS IDENTIFICATION

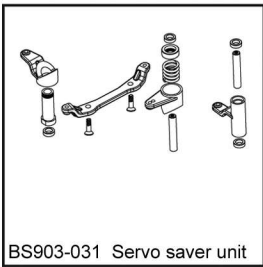

BS903-031 Servo saver unit

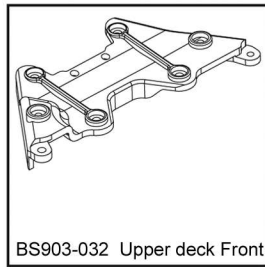

BS903-032 Upper deck Front

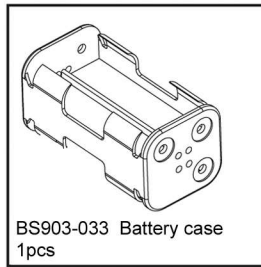

BS903-033 Battery case  
1pcs

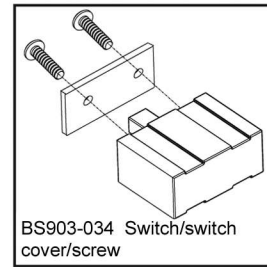

BS903-034 Switch/switch  
cover/screw



BS903-035 Receiver/battery  
case cover



BS903-036 Handle



BS903-037 Steering servo  
horn and linkage

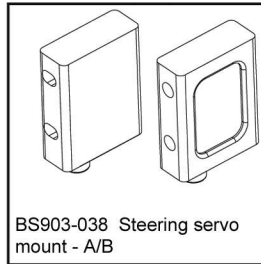

BS903-038 Steering servo  
mount - A/B

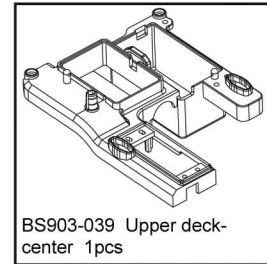

BS903-039 Upper deck-  
center 1pcs

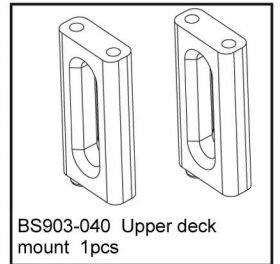

BS903-040 Upper deck  
mount 1pcs

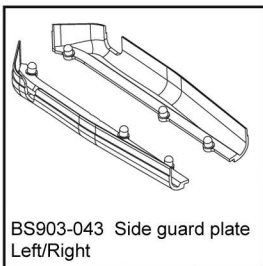

BS903-043 Side guard plate  
Left/Right

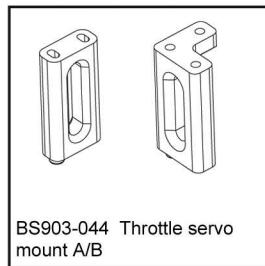

BS903-044 Throttle servo  
mount A/B

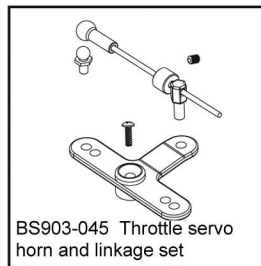

BS903-045 Throttle servo  
horn and linkage set

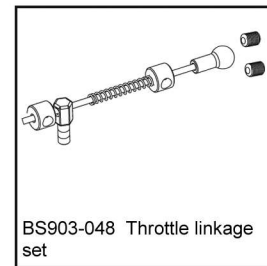

BS903-048 Throttle linkage  
set

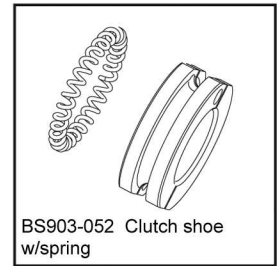

BS903-052 Clutch shoe  
w/spring

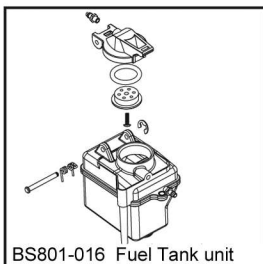

BS801-016 Fuel Tank unit

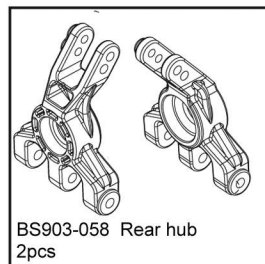

BS903-058 Rear hub  
2pcs

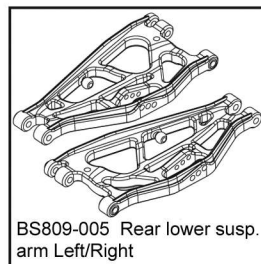

BS809-005 Rear lower susp.  
arm Left/Right

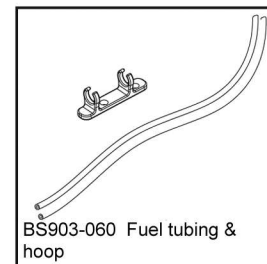

BS903-060 Fuel tubing &  
hoop

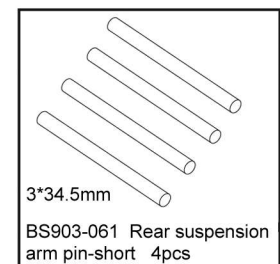

3\*34.5mm  
BS903-061 Rear suspension  
arm pin-short 4pcs

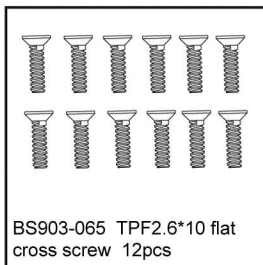

BS903-065 TPF2.6\*10 flat  
cross screw 12pcs

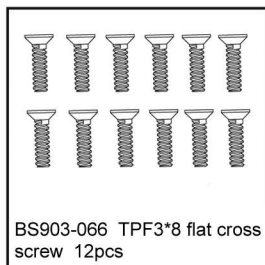

BS903-066 TPF3\*8 flat cross  
screw 12pcs

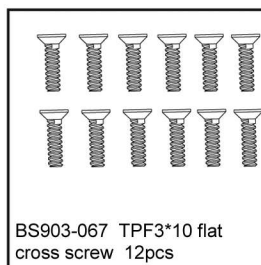

BS903-067 TPF3\*10 flat  
cross screw 12pcs

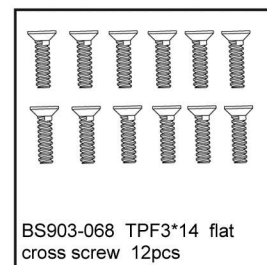

BS903-068 TPF3\*14 flat  
cross screw 12pcs

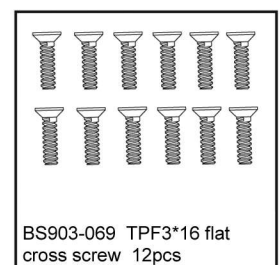

BS903-069 TPF3\*16 flat  
cross screw 12pcs

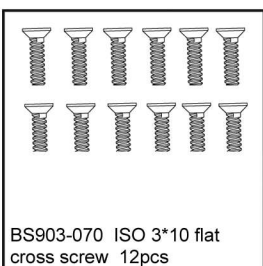

BS903-070 ISO 3\*10 flat  
cross screw 12pcs



BS903-071 BT 2.6\*6 B-head  
cross screw 12pcs

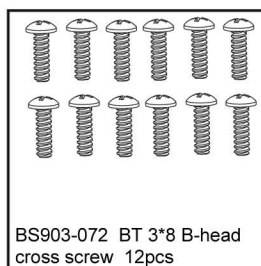

BS903-072 BT 3\*8 B-head  
cross screw 12pcs

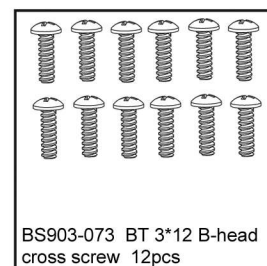

BS903-073 BT 3\*12 B-head  
cross screw 12pcs

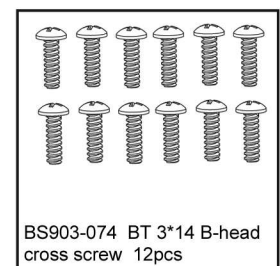

BS903-074 BT 3\*14 B-head  
cross screw 12pcs

# PARTS IDENTIFICATION



BS903-075 BT 3\*16 B-head cross screw 12pcs



BS903-076 BT 3\*20 B-head cross screw 12pcs



BS903-079 BM 3\*10 B-head cross screw 12pcs



BS902-051 BT 3\*10mm B-head cross screw 12pcs



BS903-081 HM 3\*10 Cap head hex screw 6pcs

\* For brake disc



BS903-082 Diff. outdrive D w/ M4\*4 set screw



BS903-083 Diff. outdrive C w/ M4\*4 set screw

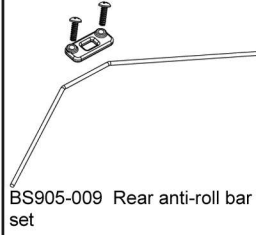

BS905-009 Rear anti-roll bar set



BS903-086 Ball bearing (5\*10\*4) 2pcs



BS903-087 Ball bearing (12\*18\*4) 2pcs



BS903-014 Ball bearing (6\*12\*4) 2pcs



BS903-016 Ball bearing (10\*15\*4) 2pcs

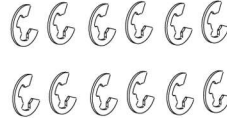

BS903-088 E-clip (4\*0.6) 12pcs

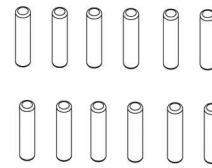

BS903-089 Pin (2\*9.5) 12pcs

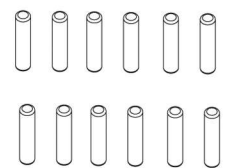

BS903-090 Pin (2\*12.5) 12pcs

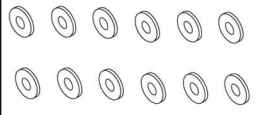

BS903-091 Washer A (5.2\*10\*0.2) 12pcs

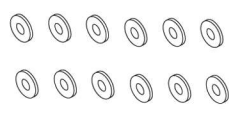

BS903-092 Washer B (4.2\*8\*0.2) 12pcs

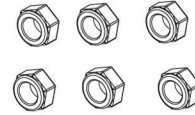

BS808-003 M5 nylon lock nut 6pcs

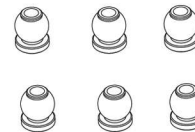

BS903-094 Double way ball end 6pcs

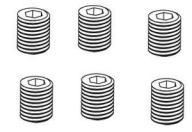

BS903-095 M4\*4 grub screw 6pcs

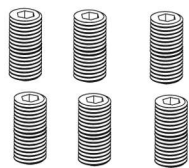

BS903-096 M4\*8 grub screw 6pcs

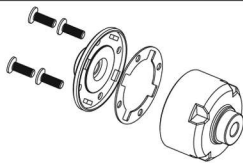

BS903-097 Diff. gearbox

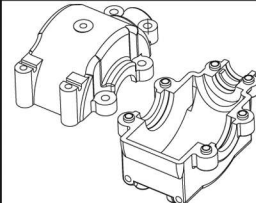

BS903-098 Diff. gearbox bulkhead upper/lower

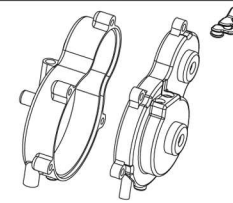

BS903-099 Gearbox bulkhead front/rear

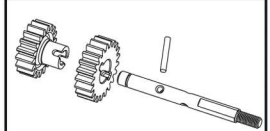

BS903-101 Pinion gear 18T/19T/pin

\* For two speed

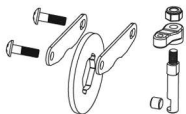

BS903-102 Brake set

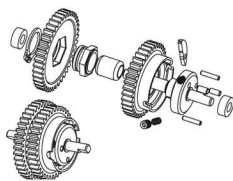

BS903-103 2 speed gear 40T/37T

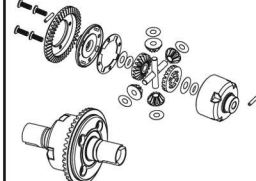

BS903-104 Diff. unit

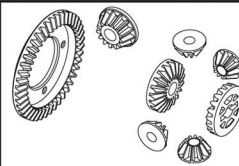

BS903-105 Drive/driven gear, Diff. gear/bevel gears

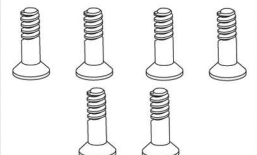

BS903-106 Screw pin (M3\*9.5) 12pcs



# PARTS IDENTIFICATION

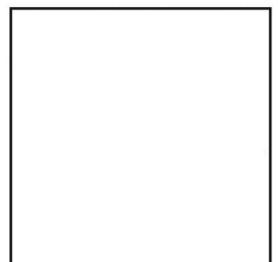
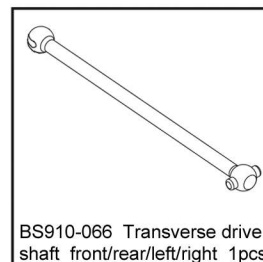
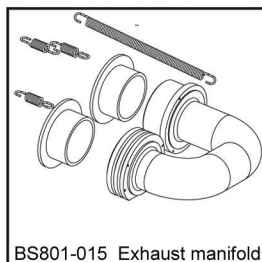
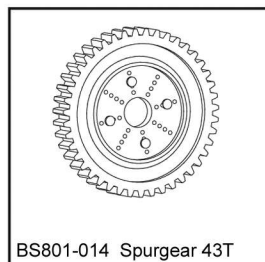
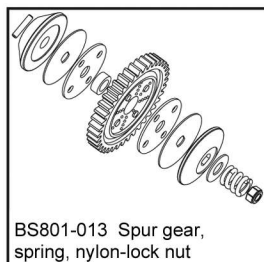
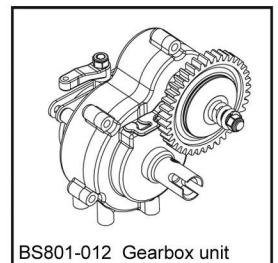
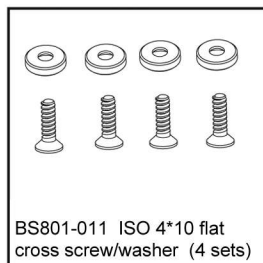
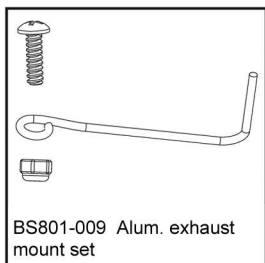
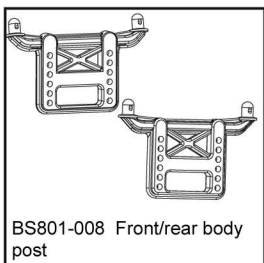
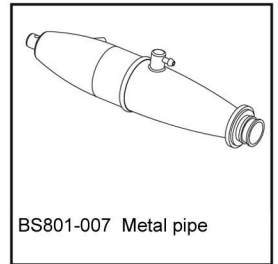
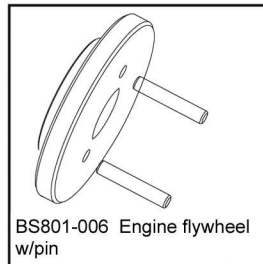
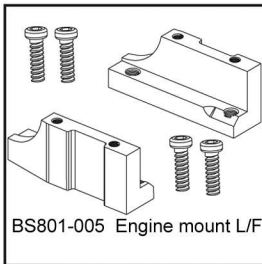
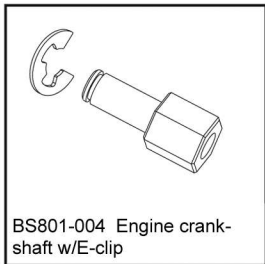
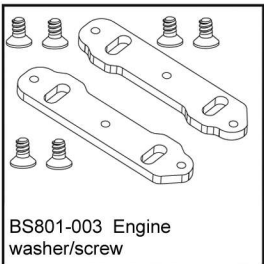
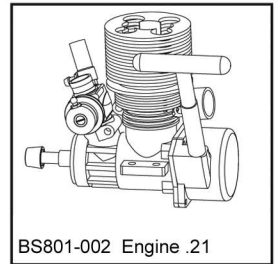
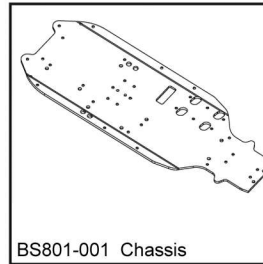
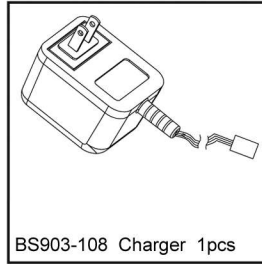
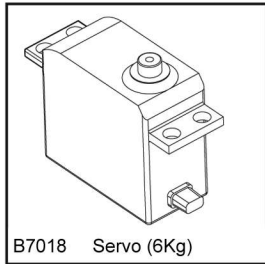
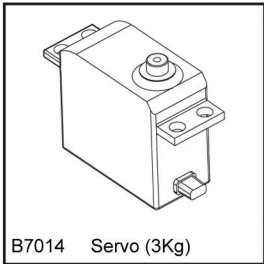
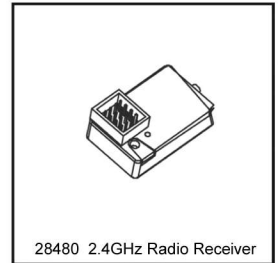
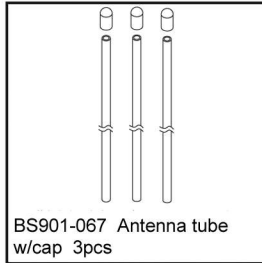
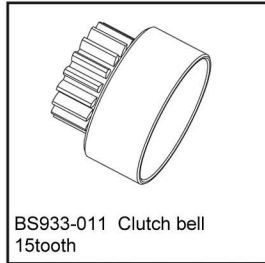
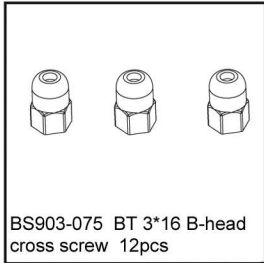

# PARTS IDENTIFICATION

Stainless steel AL6061



MPO-04 Rear hub set  
Aluminum

Stainless steel AL6061



MPO-05 Shock stay mount  
Aluminum

Stainless steel AL6061



MPO-06 Front suspension  
mount Aluminum

Stainless steel AL6061



MPO-07 Rear suspension  
mount Aluminum

Stainless steel



MPO-08 Steel brake disk

Stainless steel



MPO-09 Special brake pads

Stainless steel AL6061



MPO-10 Brake lever

Stainless steel AL6061



MPO-11 Steering link  
Aluminum

Stainless steel AL6061



MPO-12 Engine mount  
Aluminum

Stainless steel AL6061



MPO-13 Slipper system (hard  
anodized)



BS801-017 Silk-screened  
body



BS801-019 Air filter w/insert

Stainless steel AL6061



MPO-02 C hub/C hub pin

Stainless steel AL6061



MPO-03 Knuckle arm set



**www.REDCATRACING.com**

Follow us on social media

Take a photo, create a video, post and share your Redcat experience.

Stay up to date on the latest Redcat news, products, and creative content. While these profiles are not customer service channels, you might find that one of our subject experts or another member of the community is able to assist you. If you have an issue or need technical and or product support, please reach out to Redcat directly through our website.

 <https://www.facebook.com/RedcatRacing>

 <https://www.instagram.com/RedcatRacing>

 <https://www.youtube.com/RedcatRacing>

 <https://www.twitter.com/RedcatRacing>

 <https://www.pinterest.com/RedcatRacing>

#### **IMPORTANT LINKS:**

Link to the most recent version of this manual with exploded views and parts lists:  
[www.redcatracing.com/manuals/Earthquake35manual.pdf](http://www.redcatracing.com/manuals/Earthquake35manual.pdf)

Link to nitro vehicles manual:  
[www.redcatracing.com/manuals/NITRO-MANUAL.pdf](http://www.redcatracing.com/manuals/NITRO-MANUAL.pdf)