

1/8TH 4WD Nitro/Electric Power R/C Off-Road Buggy (Advanced Version)

Specifications:

LENGTH	WIDTH	HEIGHT	WHEEL BASE	DRIVE SYSTEM	GROUND CLEARANCE	DIAMETER OF WHEEL	WIDTH OF WHEEL	GEAR RATIO
490mm	305mm	190mm	325mm	4WD Shaft Drive	30mm	115mm	42mm	1:9.347 EP(1:9.347)

Electric Version Specifications

Styles	Brushless Motor (KV/Brushless Motor)	Motor RPM	Battery Specification	ESC Specification	ESC Temperature protection	Under Voltage Protection	Gear Ratio	Speed
PRO-Brushless Version	3665 (RC540)	2400KV	LiPO-11.1V-3600mAh	Brushless 80A w/ Fan	98(+/-3-5 centgrade)	below 7.2V1A	1:9.347	60KM
TOP-Brushless Edition	3665 (RC540)	1755KV	25974rpm LIPO-14.8V-3600mAh	Brushless 80A w/ Fan	98(+/-3-5 centgrade)	below 9.6V1A	1:8.828	70KM

Spare Part

85731-Front Lower Suspension Arm 2P	85741-Rear Lower Suspension Arm 2P	85706-Rear Shock Tower AL.	85707-Front Shock Tower AL.	85740-Front Bumper
85708-Front Top Plate	885026T-Carbon Fibre Front Top Plate	885024T-Centre Differentials Plate(Carbon Fibre)	85701-Center Diff Top Plate AL.	85742-Front Upper Suspension Arm 2P
85739-Rear Uprights 2P	85739T-New Rear Uprights 2P	85718-Front Hubs (L/R)	85766-Steering Arms	85717-Drive Cups 2P
85711-Wheel Hex.+ Nuts 2P				
85714-Rear Axles+pins 2P	85715-Center Diff.Joint Cups+pins 2P	85768-Diff.Cups (front/Rear) 2P	85755-Gear Box	85762-Differential Case
85736-Diff.Gears+Pins	85720H-Diff. Gear	85716-Main Gear (46T)	85727-Center Diff. Mount 2P	85722-Chassis AL.
85790-Steering Saver /Spring	88801-Front Shock Springs 2P	85702-Front Shock Absorber 2P	88802-Rear Shock Springs 2P	85703-Rear Shock Absorber 2P

Spare Part

85730-Front Lower Suspension Arm Holder	85710-Steering Ackerman Plate	85783-Rear Lower Susp. Arm Holder	85784-Front Brace	85785-Rear Brace
85756-Suspension Holders	88581-Front /rear Lower Inside Hinge Pin Set 6mm 4P	85751-Front Upper Inside Hinge Pins 51mm 2P & Rear Lower Outside Hinge Pins 49.5mm 2P	85791-Antenna Pipes 4pcs	85803-Pins 2.5*11 2P
85808-Pins 3*17 3P	85757-Servo Link	85767-Steering Links 2P	85743-Rear Upper Link 85743T-New Rear Upper Link	85704-Rear Dogbones 107mm 2P
85705- Center Dogbones (Front+Rear) 2P	85712-Front Universal Dogbones 2P	B81302-Shock Mount (To Install Shock To Shock Tower)	85765-Steering Posts 2P	85798-Front Shock Shafts +Pistons 2P
85800-Rear Shock Shafts +Pistons 2P	85749-Front Sway Bar +Links	85750-Rear Sway Bar +Links	Sp9001-Steering Servo 9kg	85786-Body Post
85854-Wing Reinforcement Holder	85759-Wing Stay Posts	85758-Wing Stay 2P	88807-Adjustable Wing Mount 2P	85738-Side Guard(L/R)
85737-Tail Wing	81H903-Tail Wing	08155-Tire Insert Sponge 2P	85890-Tires 2P	85732-Wheel Rims 2P

Special Spare Parts Of NP Models

85754-Servo Linkage Complete	SP3003-Servo unit 3kg SP3004-Servo unit 3kg (Optional)	02070-Battery Compartment	85733-Battery/Receiver Box	85721-Fuel Tank(125cc)
85753-Fuel Pipes 2P	85761-Fuel Filter Holder +Splash Guard	85804-Fuel Pipe Holder	85805-Fuel Inlets 2P	85806-Fuel Tank Spring
85747-Air Fuel Complete	85748-Air Fuel Sponges 2P	85789-Tuned Pipe	85788-Tuned Pipe Joint Tubing(Silicone)	70007-Mainfold
85764-Exhaust Pipe Holder	85723-Engine Holder/ Mount	85735-Engine Flywheel	85787-Engine Flywheel Nut 2P	Engine SH21CXP/ SH28CXP&HSP 26CXP 30CXP
85745-Clutch Shoes +Springs 3P	85726-Switch Housing 2P	85752-Brake Discs+Pads 2P	85713-Brake Cams 2P	Optional

Special Spare Parts Of EP Models

E98510-Battery Case	E98511-Receiver Case/ Servo Mount	E98512-Joint Plate	E98513-Motor Mount	E98105-Motor Mount
61028-Brushless Motor 3000KV	13308-Brushless ESC (80A)	E98106-Battery Bandage	03019-Battery (7.2V.3000mAh)	E98514-Steering Arm
E98107-Motor Gear (16T)	E98516-Screw pack (3*10 2P/3*10 6P/4*10 2P/3*10 5P/M3 2P)	E98515-Screw pack (M3*10 2P/M3*10 2P/M4*10 1P/M3*8 4P/M4*12 2P/M3*10 1P/4*4 1P)		

Optionals

80135-Transmitter 2-Channel AM	02071-Receiver AM	80310-Transmitter 2-4G	28464-Receiver 2.4GHZ	80300-Transmitter 2-Channel 2.4G	28464-Receiver 2.4GHZ
80302-Transmitter 2-Channel 2.4G	28463-Receiver 2.4GHZ	80301-Transmitter 2-Channel 2.4G	28463-Receiver 2.4GHZ	80226G-Transmitter 3-Channel 2.4G	28462-Receiver 2.4GHZ

Upgradable Optionals

885026T-Front Top Plate (Carbon Fibre)	885031-Front Upper Suspension holder(AL)	885028-Front Lower Suspension Pad (AL)	885030-Rear Lower Suspension Pad (AL)	885035-Front Brace (AL)
885034-Rear Lower Suspension Holder(AL)	885032-Front Lower Suspension Holder (AL)	885036-Rear Brace (AL)	885040-Alum. Steering Ackerman	885012-Rear Uprights 2P (AL)
885024T-Centre Differentials Plate (Carbon Fibre)	885023-Rear Shock Plate (AL)	885022-Front Shock Plate (AL)	885211-Carbon Fibre Rear Shock Tower	885212-Carbon Fibre Front Shock Tower
885025-Center Diff. Mounts 2P(AL)	885018-Front Upper Suspension arms 2P (AL)	885019-Front Lower Suspension arms 2P (AL)	885021-Rear Lower Suspension arms 2P (AL)	885045-Wing Brace Mount (AL)
885037-Body Post(AL.)	885047-Wing Stay Post (AL.) 2P	885546-Wing Mount Buttons 2P (AL)	885020-Rear Upper Link (AL)	885016-Rear Drive Joints 2P
885014-Centre Drive Joints (long)	885013-Centre Drive Joints (short)	04103-Alum. capped air filter cover	885002T-Carbon Fibre Radio Plate	61921-Brushless Motor 1755KV
61920-Brushless Motor 2400KV	28434-Battery (LiPO-11.1V-3600mAh)	28148-Battery (LiPO-14.8V-3600mAh)	03204-Battery (LiPO-7.4V-3600mAh)	For EP Model

Spare Part

85746-Wheels Complete 2P	81289-Wheel Rims 2P	85746N-Wheels Complete 2P	02053-R- Clips 6P	02103-Zip Ties 6P
85744-Shock Cup Tension Clips 12P	85796-Ball Ends 85796T-New Ball Ends	85769-Fuel Tank Bushes	85799-Steering Plate Bushes 4P	85792-Adjustable Bushes Complete
85850-Shock Insert Upper Cups 4P	02139-Bearings 10*5*4 4P (For Clutch Bell)	85763-Bearings 16*8*5 8P	85780-Steering Post Bushings 4P	85781-Shock Seals 8P
85782-Differential Seals 6P	85814-Washer 2.7*6.0*0.5 (For Flywheel Pin Mount) 6P	85812-Washer 6.5*3.0*0.5 (For Shock Shaft) 6P	85811-Washer 8*5.2*0.3 (For Engine Crank Mount) 6P	85813-Washer 12*3.1*0.5 (For shock balls Mount) 6P
85810-Washer 16*13.1*0.3 (For Gear Box Bearing Mount) 6P	85809-Washer 17*6.2*0.3 (For Differentials Mount) 6P	85779-Front Hub Caps 4P	85770-Shock Boots (front 2P+ rear 2P)	85778-Front Suspension Arm Balls 4P
85777-Sway Bar Balls 6P	85776-Shock Balls 6P	85773-Rear Upper Arm Balls B 6P	85773-New Rear Upper Arm Balls B 6P	85774-Steering Link Balls B 6P
85775-Steering Link Balls A 6P	85793-Nylon Nuts M3 6P	85794-Nylon Nuts M4 8P	85832-Set Screws M3*3 12P	85833-Set Screws M4*10 4P

Spare Part

85834-Set Screws M5*4 6P	02099-Set Screws M4*4 8P	02098-Set Screws M3*4 12P	85835-Ball Head Self Tapping Screws 2*24 4P	85719H-Diff. Pinions 2P
85836-Steering Plate Screws 6P	85816-Cap Head Hex. Machine Screws 4*10 8P	85817-Cap Head Machine Screws 4*26 4P	85818-Cap Head Machine Screws 3*14 8P	85819-Cap Head Machine Screws 3*16 6P
85844-Ring Head Self Tapping Screws 3*8 4P	85820-Cap Head Machine Screws 3*20 4P	85828-Flat Head Hex. Machine Screws 4*18 4P	85829-Flat Head Hex. Self-Tapping Screws 4*18 12P	02095-M3*8 Column Head Hex. Screws 4P
85839-Flat Head Hex. Machine Screws 4*6 8P	85840-Flat Head Hex. Machine Screws 4*26 4P	85841-Flat Head Hex. Machine Screws 4*42 4P	85837-Flat Head Self Tapping Screws 3*10 12P	85838-Flat Head Self Tapping Screws 3*18 10P
85826-Flat Head Self Tapping Screws 3*16 4P	85830-Flat Head Self Tapping Screws 4*22 4P	85831-Flat Head Self Tapping Screws 4*30 4P	85821-Rounded Head Machine Screws 3*12 10P	85822-Rounded Head Machine Screws 3*10 10P
85823-Rounded Head Machine Screws 4*12 8P	85824-Rounded Head Machine Screws 4*40 4P	85846-Rounded Head Machine Screws 3*14 8P	85842-Rounded Head Self Tapping Screws 4*14 6P	85843-Rounded Head Self Tapping Screws 3*12 4P
85845-Rounded Head Self Tapping Screws 3*8 4P	85848-Rounded Head Self-Tapping Screws 2*6 4P	85852-Rounded Head Hex. Machine Screws 3*8 6P	85853-Rounded Head Hex. Machine Screws 3*10 6P	85849-Column Head Hex. Machine Screws 3*24 4P

Special Spare Parts Of NP Models

85724-Clutch Bell(14T)	85795-Radio Plate Posts	85709-Radio Tray AL.	885002T-Carbon Fibre Radio Plate	02072-Servo/throttle Horns
------------------------	-------------------------	----------------------	----------------------------------	----------------------------

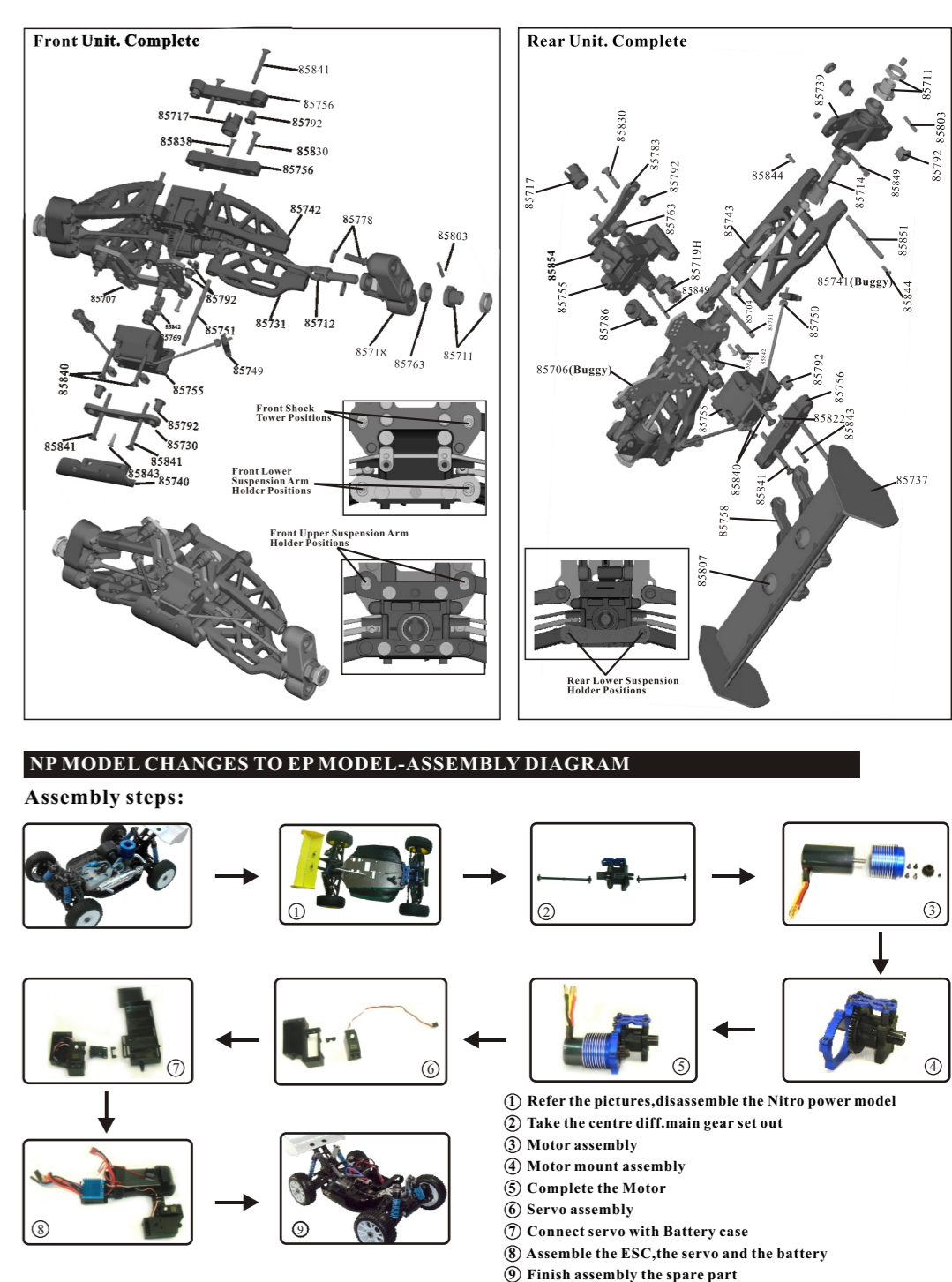
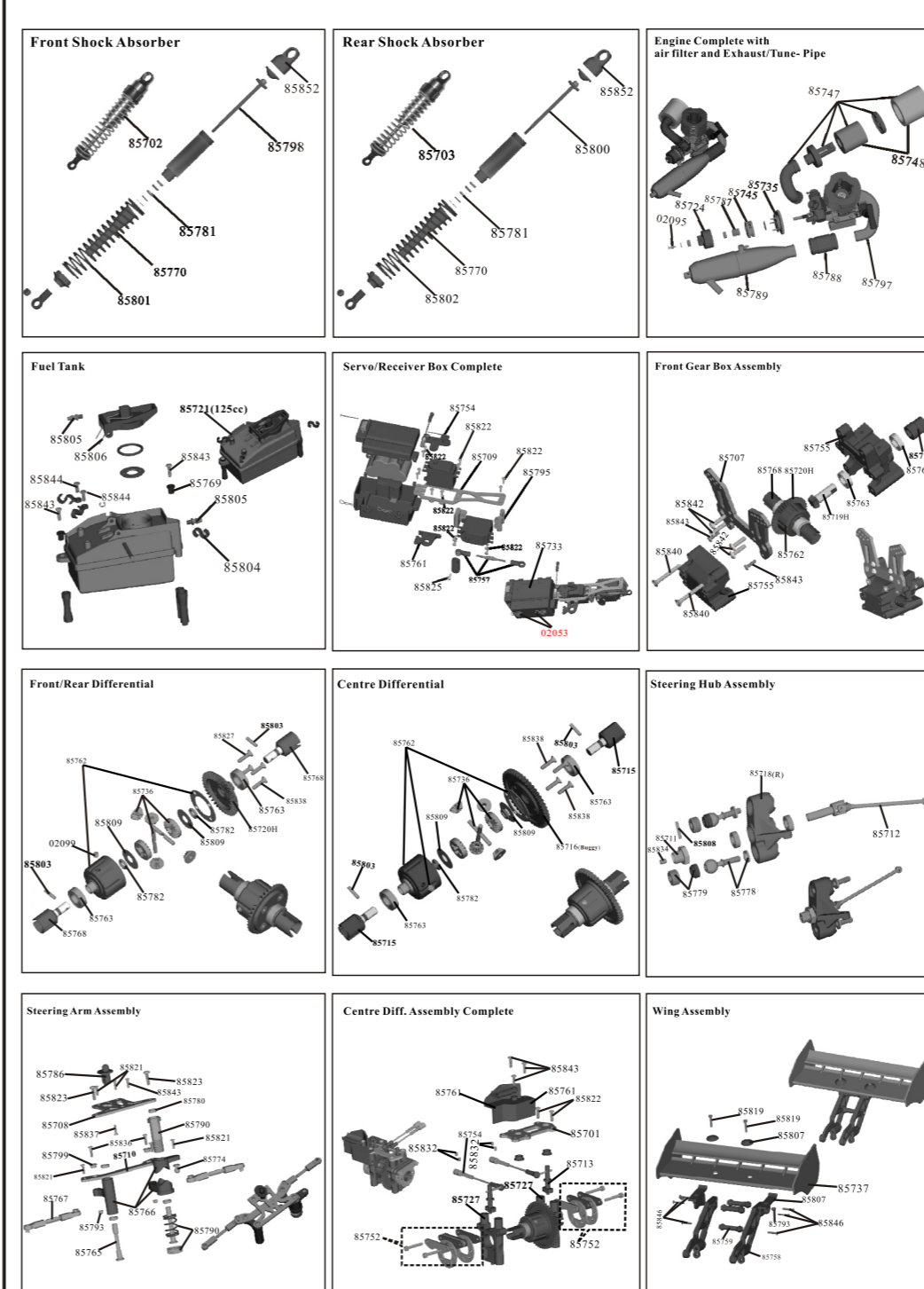

- NP MODEL CHANGES TO EP MODEL-ASSEMBLY DIAGRAM**
- Assembly steps:**
1. Assemble the chassis and suspension components.
 2. Assemble the motor and servo components.
 3. Assemble the battery and ESC components.
 4. Assemble the transmitter and receiver components.
 5. Assemble the fuel tank and engine components.
 6. Assemble the steering and gear components.
 7. Assemble the shock absorbers and springs.
 8. Assemble the wheels and tires.
 9. Assemble the final chassis and body components.
- ① Refer the pictures,disassemble the Nitro power model
② Take the centre diff.main gear set out
③ Motor assembly
④ Motor mount assembly
⑤ Complete the Motor
⑥ Servo assembly
⑦ Connect servo with Battery case
⑧ Assemble the ESC,the servo and the battery
⑨ Finish assembly the spare part